

2008 Kentucky Fruit and Vegetable Conference and Trade Show

JANUARY 7-8, 2008
Monday and Tuesday

Kentucky State Horticulture Society
152nd Annual Meeting

Kentucky Vegetable Growers Association
37th Annual Meeting

Kentucky Farmers' Market Association
2nd Annual Meeting

The Kentucky Grape and Wine Short Course

*In cooperation with:
University of Kentucky
College of Agriculture
Kentucky State University
Kentucky Department of Agriculture*

Meeting Place:
Embassy Suites Hotel
1801 Newtown Pike
Lexington, Kentucky 40511
(859) 455-5000
FAX (859) 455-5122
Reservations: 800-EMBASSY

Meeting Outline

Sunday, January 6

Room

6:00-8:00 p.m.	Preconference Reception and Kentucky Farmers' Market Association Annual Meeting	Coldstream 5
7:00-9:00 p.m.	Exhibitor Set-up	
7:30-9:30 p.m.	Preconference Fruit Round Table Discussion	Bourbon

Monday, January 7

8:00 a.m.	Exhibits Open	
8:50 a.m.	<u>Concurrent Sessions</u>	
	KSHS-KVGA Joint Session	Coldstream 3
	Beginning Grape Growers Workshop	Bourbon
10:30 a.m.	Break	
Noon	Exhibitors & Growers Luncheon	Coldstream 1 & 2
1:30 p.m.	<u>Concurrent Sessions</u>	
	Winemaking	Coldstream 1 & 2
	Vegetable Production	Coldstream 3
	Farmers' Markets	Coldstream 4
	Commercial Tree Fruit Production	Coldstream 5
	Produce Buyer Meetings (See schedule at meeting).....	Bourbon
2:30 p.m.	Break	
5:15 p.m.	Exhibits Close	
5:30 p.m.	Celebration of Kentucky Wines	Coldstream 1 & 2
6:30 p.m.	Banquet	Coldstream 3

Tuesday, January 8

8:00 a.m.	Exhibits Open	
8:30 a.m.	<u>Concurrent Sessions</u>	
	Grape & Wine Short Course	Coldstream 1 & 2
	Vegetable Production	Coldstream 3
	Organic Farming and Gardening	Coldstream 4
	Tree Fruit	Coldstream 5
	Blueberry Production	Bourbon
10:00 a.m.	Break	
11:40 a.m.	Lunch on Your Own	
1:30 p.m.	<u>Concurrent Sessions</u>	
	Grape & Wine Short Course	Coldstream 1 & 2
	Good Agricultural & Handling Practices Workshop	Coldstream 3
	Business Management and Marketing	Coldstream 4
	Small Fruit Production	Coldstream 5
2:30 p.m.	Break	
3:00 p.m.	Exhibit Hall Closes	
7:00 p.m.	Kentucky Vintners' Dinner	Coldstream 1, 2, & 3

Dear Kentucky Vegetable and Fruit Grower:

The 2008 Fruit and Vegetable Conference and Trade Show will be at a new location, the Embassy Suites Hotel, Lexington, KY, Monday and Tuesday, January 7 and 8, 2008. This hotel is across the street from where the meetings have been held in the past. Highlights of this year's meeting will be sessions on Farmers' Markets, Commercial Fruit and Vegetable Production, Small Fruit Production, Organic Farming and Gardening, the Grape and Wine Short Course, Winemaking, Business Management and Marketing, and a Good Agricultural and Handling Practices Workshop.

Special out-of-state speakers include: Dr. Wayne Wilcox, Research and Extension Fruit Pathologist, Cornell University, Geneva, NY; Jeff Kindhart, Senior Research Specialist, Dixon Springs Agricultural Center, Simpson, IL; Dr. Annette Wszelaki, Extension Vegetable Specialist, Department of Plant and Soil Science, University of Tennessee, Knoxville, TN; Donna Winchell, Ohio Grape and Wine Industries, Geneva, OH; Michael Schmidt, Spec Trellising, Ivyland, PA; Dr. Dave Lockwood, Extension Fruit Specialist, University of Tennessee, Knoxville, TN; and Read Jordon, Risk Management Agency, Flowood, MS.

The KVS will have an optional Celebration of Kentucky Wines featuring Kentucky wines prior to the banquet. Dr. Jimmy Henning, U.K. Director of Cooperative Extension, will speak on the College of Agriculture Vision for the Future and we will relax to the tunes of the U.K. Jazz Cats at the banquet. This year the KVS will host a special Vintners' Dinner on the evening of January 8th.

We will have a Trading Post bulletin board to sell used equipment. If you are looking for equipment buyers, bring along a description containing your name, phone number and the equipment price.

PLEASE make your room reservations directly with the hotel. Our block of rooms will be held until Dec. 15, 2007. Be sure to let the hotel know that you will be staying for the Kentucky Fruit and Vegetable Growers Conference to obtain our special suite room rate (they are all suites) of \$99.00. This includes an evening managers reception with drinks and a full cooked-to-order breakfast daily. We encourage growers to stay at Embassy Suites Hotel as the organizations have guaranteed that we will use at least 125 sleeping rooms or we will make up the difference.

The \$20 meeting registration fee includes a year's membership in the KVGA or KSHS and entrance into the Grape & Wine Short Course. Membership in the KVGA also allows growers to use pesticides that have received 24c registrations for Kentucky. Please see the registration form to become a member of the Kentucky Vineyard Society and to sign up for the meal functions and the Celebration of Kentucky Wines.

The enclosed registration form enables you to register in advance so your tickets and name tags will be ready for you when you arrive at the meeting. NOTE: WE STRONGLY URGE YOU TO PRE-REGISTER. BANQUET AND LUNCHEON TICKETS CAN ONLY BE PURCHASED BY ADVANCE REGISTRATION. NAME BADGES WILL BE REQUIRED TO ENTER MEETING ROOMS. **PRE-REGISTRATION FORMS NEED TO BE IN OUR HANDS BY WEDNESDAY DECEMBER 19, 2007.** If you would like to serve on the KVGA or KSHS boards of directors or would like to nominate another member, please designate this on your registration sheet.

If circumstances are such that you cannot attend the meeting, please complete and return the form to Ms. Mary Ann Kelley, Research & Education Center, P.O. Box 469, Princeton, KY 42445 to continue your association membership.

Sincerely,

Robert Stone, President
KY Vegetable Growers Association

Maurice Fegenbush, President
KY State Horticultural Society

**KENTUCKY STATE HORTICULTURAL
SOCIETY OFFICERS**

President: Maurice Fegenbush, Bloomfield

Vice-Presidents: Terry Boyd, Versailles
Terry Creech, Cumberland
Charles (Bill) DeHaven, Owensboro
Larry Ayres, Owenton
Jeremy Hinton, Hodgenville
Ray Armstrong, Shepherdsville
Cal Blake, Lexington
Kevan Evans, Georgetown
Linda Ison, Crestwood
Ed Fackler, New Salisbury, IN
Don Haney, Nancy
Billy Reid, Owensboro
Paul Tokosh, Pleasureville

Secretary: Doug Archbold, Lexington

Treasurer: Cindy Peake, Mt. Sterling

Advisors: Rick Durham, Lexington
Joe Masabni, Princeton
Kirk Pomper, Frankfort
John Strang, Lexington

**KENTUCKY VEGETABLE GROWERS
ASSOCIATION OFFICERS**

President: Robert Stone, Paris

Vice-President: Butch Case, Cynthia

Secretary: Beth Wilson, Nancy

Treasurer: Jim Kirby, Winchester

Directors: Larry Snell, Elizabethtown
Kevin Trunnel, Utica
Joel Wilson, Nancy
John Bell, Georgetown
Roland McIntosh, Stanton
Bill Holleran, Jr., Lexington
Brent Lackey, Somerset
Zeldon Angel, Winchester
Annette Meyer-Heisdorffer, Owensboro
C. A. Pantle, Jr., Owensboro
Linda McMaine, Salvisa

Advisors: Tim Coolong, Lexington
Terry Jones, Quicksand
Joe Masabni, Princeton
Mac Stone, Frankfort
John Strang, Lexington

**KENTUCKY VINEYARD SOCIETY
ASSOCIATION OFFICERS**

President: Chuck Smith, New Castle

Vice-President: Zane Burton, Somerset

Secretary: Kaan Kurtural, Lexington

Treasurer: Harkey Edwards, Lexington

Directors: Bob Karsner, Willisburg
Lowell Land, Richmond
Dave Loney, Mays Lick
Bob Miller, Richmond
Chad Peach, Frankfort
Ed Singleton, Waynesburg
Jim Wight, Shepherdsville

Advisors: Chris Smigell, Lexington

All Times Are Eastern Standard Time

SUNDAY, JANUARY 6

6:00 p.m. **PRECONFERENCE RECEPTION AND KENTUCKY FARMERS'
MARKET ASSOCIATION ANNUAL MEETING**
Coldstream 5 Room, Janet Eaton, Presiding

7:00-10:00 p.m. Exhibitor Set-up -- Pre-Function Area & Lower Atrium

7:30 p.m. **PRECONFERENCE FRUIT ROUND TABLE DISCUSSION**
Bourbon Room, John Strang, Presiding

9:00 p.m. Adjourn

MONDAY, JANUARY 7

8:00 a.m. Exhibits Open, Pre-Function & Lower Atrium Areas

8:30 a.m. Registration, Pre-Function area outside meeting rooms

Meeting registration plus one-year membership in either the Kentucky Vegetable Growers Association or Kentucky State Horticultural Society is \$20.00. Please see the registration form for Kentucky Vineyard Society registration.

(1) KSHS - KVGA JOINT SESSION

*Coldstream 3 Room
Robert Stone, Presiding*

(2) BEGINNING GRAPE GROWERS WORKSHOP

*Bourbon Room
Chuck Smith, Presiding*

8:50 a.m. Welcome - *Maurice Fegenbush*

9:00 a.m. Horticulture Council Update
- *Dewayne Ingram, Tim Coolong & John Strang*

9:15 a.m. Kentucky Department of Agriculture Produce
Marketing Update - *Mac Stone*

9:30 a.m. Fungicide Resistance - *Wayne Wilcox*

10:00 a.m. Agrotourism Linkages to the Kentucky Fruit
and Vegetable Industry
- *Stephen Yates and Kristen Branscum*

10:15 a.m. The Kentucky Farm to School Produce
Marketing Program - *Sara Williamson*

10:30 a.m. Cider/Coffee Break and Visit Exhibits
- Pre-Function and Lower Atrium Areas

11:00 a.m. Population Dynamics of Human Pathogens in
Association with Plant Products - *Paul Vincelli*

11:30 a.m. The Non-insured Disaster Assistance Program
(NAP) and Crop Disaster Program (CDP)
- *Marcinda Kester*

11:45 a.m. Risk Management Agency Crop Insurance
- *Read Jordan*

12:00 noon **EXHIBITORS AND GROWERS LUNCHEON** - Coldstream 1 & 2 Rooms

12:00 noon. **KVGA AND KSHS BOARD MEETINGS**

Kentucky State Horticultural Society - Paris Room

Kentucky Vegetable Growers Association - Georgetown Room

Board members should pick up their lunch at the buffet in Coldstream 1 & 2 and then meet in the designated room at the top of the stairs located over the meeting rooms.

5 CONCURRENT SESSIONS

Concurrent sessions will enable participants to attend topics of interest in different sessions.

MONDAY AFTERNOON, JANUARY 7

(3) WINEMAKING

*Coldstream 1 & 2 Rooms
Patsy Wilson, Presiding*

- 1:30 p.m. Marketing: Romancing the Retailer
- *Rachael Peake*
- 2:00 p.m. Sulfur Dioxide Management
- *Tom Cottrell*
- 2:30-3:10 Cider/Coffee Break and Visit Exhibits
- Pre-Function and Lower Atrium Areas
- 3:10 p.m. Marketing: Convincing the Customer
- *Rachael Peake*
- 3:40 p.m. Fixing Defective Wines
- *Tom Cottrell*

(4) VEGETABLE PRODUCTION

*Coldstream 3 Room
Robbie Smith, Presiding*

- 1:30 p.m. Spray Programs for Tomatoes and Cucurbits
- *Kenny Seebold and Ric Bessin*
- 2:00 p.m. Vegetable Cultivar Trial Results
[Fall Staked Tomatoes, Super Sweet Corn,
Specialty Melons, Seedless Watermelons]
- *Terry Jones and Chris Smigell*
- 2:30-3:10 Cider/Coffee Break and Visit Exhibits
- Pre-Function and Lower Atrium Areas
- 3:10 p.m. Romaine Lettuce Production
- 2007 Experiences
- *Dave Spalding, Butch Case and Zeldon Angel*
- 4:10 p.m. Tomato and Sweet Corn Varieties that Please
the Grower and Consumer
- *Annette Wszelaki*

MONDAY EVENING, JANUARY 7

5:15 p.m. **Exhibits Close**

5:30 p.m. **CELEBRATION OF KENTUCKY WINES**

*Featuring the Evaluation of Commercial Kentucky Products
- Coldstream 1 & 2 Rooms*

Sponsored by the KVS, (Acres of Land Winery, Elk Creek Vineyards, Equus Run Vineyards, Horseshoe Bend Vineyards, Long Lick Farm Winery, Stone Brook Winery, and Wildside Vines. The cost is \$10.00 for the tasting.)

6:30 p.m. **BANQUET**, Coldstream 3 Room
Robert Stone, Presiding

Speaker: *The College of Agriculture Vision for the Future.*

Jimmy Henning, Associate Dean for Extension, Director Cooperative Extension Service,
U.K. College of Agriculture

Entertainment: *An Evening of Jazz with the U.K. Jazz Cats*

Joe Carucci - Saxophone, Ross Whitaker - Guitar, Matt Davidson - Brass, and Phil Robb - Drums

5 CONCURRENT SESSIONS

Concurrent sessions will enable participants to attend topics of interest in different sessions.

MONDAY AFTERNOON, JANUARY 7

(5) FARMERS' MARKETS

*Coldstream 4 Room
Janet Eaton, Presiding*

- 1:30 p.m. Markets Around the World
- *Bob Geneve*
- 2:00 p.m. Developing Your Farm
Web Site
- *Patricia Dillon*
- 2:30-3:10 Cider/Coffee Break and
Visit Exhibits
- Pre-Function and Lower
Atrium Areas
- 3:10 p.m. Exceptional Varieties for
Farmers' Markets Sales
(panel discussion)
- *Ralph Packard, Bonnie
Sigmon, Ron and Linda
McMaine*
- 3:40 p.m. Farm Inspections
- *Jeff Dabbelt*
- 4:10 p.m. Equipment for Small and
Older Farmers
- *Terry Jones*

(6) COMMERCIAL TREE FRUIT PRODUCTION

*Coldstream 5 Room
Dennis Morgeson, Presiding*

- 1:30 p.m. Fruit Site Selection
Using GPS
- *Kaan Kurtural*
- 2:00 p.m. Improving Soil Drainage on
Poorly Drained Fruit Sites
- *Stephen Workman*
- 2:30-3:10 Cider/Coffee Break and
Visit Exhibits
- Pre-Function and Lower
Atrium Areas
- 3:10 p.m. Cold Injury and Recovery
on All Fruit Crops
- *Dave Lockwood*
- 3:40 p.m. Diseases of Berry Crops
- *Wayne Wilcox*
- 4:10 p.m. Drought Stress and What to
Expect on All Fruit Crops
Next Year
- *Dave Lockwood*

(7) PRODUCE BUYER MEETINGS

Bourbon Room

1:30 p.m.

Wholesale representatives from:

Cabbage, Inc.
Coastline
Crossett Company
Kaitlyns Honey
Rebecca Grace
Robys
Stanley Brothers
Wal-Mart/Custom Pac
Whole Foods Market

**See schedule at meeting for
buyer time slots.

5 Concurrent Sessions

Concurrent sessions will enable participants to attend topics of interest in different sessions.

TUESDAY MORNING, JANUARY 8

8:00 a.m. Exhibits Open, Lobby

8:00 a.m. Registration -- Pre-function area outside meeting rooms.

(8) GRAPE & WINE SHORT COURSE

Coldstream 1 & 2 Rooms

Patsy Wilson, Presiding

- 8:55 a.m. Welcome Address
- *Chuck Smith*
- 9:00 a.m. Cultivar Trial Update
- *Kaan Kurtural*
- 9:20 a.m. Cropping Vidal Blanc in Kentucky
- *Patsy Wilson*
- 9:35 a.m. Effect of Japanese Beetle Feeding on Cold
Hardiness of Wine Grapes
- *Derrick Hammons*
- 10:00-10:40 Cider/Coffee Break and Visit Exhibits
- Pre-Function and Lower Atrium Areas
- 10:40 a.m. Control of Powdery Mildew in Vineyards
- *Wayne Wilcox*
- 11:10 a.m. Effect of Cultural Treatments on Vidal
Blanc Wines
- *Patsy Wilson*
- 11:40 a.m. LUNCH ON YOUR OWN

(9) VEGETABLE PRODUCTION

Coldstream 3 Room

Courtney Flood, Presiding

- 8:30 a.m. Green and Bulb Onion Production
for Farmers Markets
- *Tim Coolong*
- 9:00 a.m. Herbicide Update + KVGA
Annual Business Meeting
- *Joe Masabni*
- 9:30 a.m. Grower Vegetable Demonstration Plot
Results - *Nathan Howard, Nathan Howell,
Bonnie Sigmon, Courtney Flood
and Dave Spalding*
- 10:00-10:40 Cider/Coffee Break and Visit Exhibits
- Pre-Function and Lower Atrium Areas
- 10:40 a.m. Plastic Mulch Recycling
- *John Wilhoit*
- 11:10 a.m. Early Season High Tunnel Tomato
Production
- *Jeff Kindhart*
- 11:40 a.m. LUNCH ON YOUR OWN

TUESDAY AFTERNOON, JANUARY 8

(13) GRAPE AND WINE SHORT COURSE

Coldstream 1 & 2 Rooms

Brandon O'Daniel, Presiding

- 1:30 p.m. Marketing Essentials for Commercial
Growers
- *Donna Winchell*
- 2:00 p.m. (continued)
- 2:30-3:10 Cider/Coffee Break
- Pre-Function and Lower Atrium Areas
- 3:10 p.m. Marketing Opportunities/Services for
Kentucky Growers
- *John Carpenter*
- 3:40 p.m. State of the Industry
- *Mac Stone, Dennis Walter,
and Stacia Alford*

(14) GOOD AGRICULTURAL & HANDLING PRACTICES WORKSHOP

Coldstream 3 Room

Janet Eaton, Presiding

- 1:30 p.m. Produce Safety Overview
- *Mark Reed*
- 2:00 p.m. How Contamination Takes Place
- *John Strang and Janet Eaton*
- 2:30-3:10 Cider/Coffee Break
- Pre-Function and Lower Atrium Areas
- 3:10 p.m. Worker Hygiene and Health
- *Mark Reed*
- 3:40 p.m. Water Contamination and Flooding
- *John Strang*
- 4:10 p.m. Containers, Transport, Cooling, Handling,
Washing and Record Keeping
- *John Strang and Janet Eaton*

7: 00 p.m. KENTUCKY VINTNER'S DINNER

Coldstream Ballroom 1, 2, & 3

5 Concurrent Sessions

Concurrent sessions will enable participants to attend topics of interest in different sessions.

(10) ORGANIC FARMING AND GARDENING

*Coldstream 4 Room
Michael Fitzgerald, Presiding*

(11) TREE FRUIT

*Coldstream 5 Room
Dwight Wolfe, Presiding*

(12) BLUEBERRY PRODUCTION

*Bourbon Room
Jamie Dockery, Presiding*

8:30 a.m.	Solarization for Organic Control of White Mold in High Tunnels - <i>Mike Bomford</i>	8:30 a.m.	Phytophthora Disease in Tree Fruits - <i>Wayne Wilcox</i>	8:30 a.m.	Blueberry Disease Management - <i>John Hartman</i>
9:00 a.m.	Organic Greens Variety Trials - <i>Derek Law</i>	9:00 a.m.	Interesting Peach Tree Characteristics - <i>John Strang</i>	9:00 a.m.	Blueberry Production (Roundtable discussion) - <i>John Brainard & Jerry Eye</i>
9:30 a.m.	Organic Certification Process - <i>Michael Fitzgerald</i>	9:30 a.m.	Tree Fruit Spray Guide Update - <i>John Hartman, Ric Bessin and Joe Masabni</i>	9:30 a.m.	Trickle Irrigation Design for Blueberries - <i>Richard Warner</i>
10:00 a.m.	Cider/Coffee Break and Visit Exhibits - Pre-Function and Lower Atrium Areas	10:00 a.m.	Cider/Coffee Break and Visit Exhibits - Pre-Function and Lower Atrium Areas	10:00 a.m.	Cider/Coffee Break and Visit Exhibits - Pre-Function and Lower Atrium Areas
10:40 a.m.	Berries at Bryan Station CSA - <i>Erik Walles</i>	10:40 a.m.	Cicada Control for 2008 - <i>Ric Bessin</i>	10:40 a.m.	Weed Control - <i>Joe Masabni</i>
11:10 a.m.	What Would You Do Without Herbicides? Weed Control in Organic Systems - <i>Annette Wszelaki</i>	11:10 a.m.	KSHS Annual Business Meeting	11:10 a.m.	Varietal Blueberry Wines - <i>Tom Cottrell</i>
11:40 a.m.	LUNCH ON YOUR OWN	11:40 a.m.	LUNCH ON YOUR OWN	11:40 a.m.	LUNCH ON YOUR OWN

(15) BUSINESS MANAGEMENT AND MARKETING

*Coldstream 4 Room
Darold Akridge, Presiding*

(16) SMALL FRUIT PRODUCTION

*Coldstream 5 Room
Kelly Jackson, Presiding*

1:30 p.m.	Exploring Demand for Value Added Products - <i>Tim Woods</i>	1:30 p.m.	Plasticulture Strawberry Production A to Z - <i>Jeff Kindhart</i>
2:00 p.m.	Promoting Fruit and Vegetable Phytochemical Health Benefits - <i>Doug Archbold</i>	2:00 p.m.	(continued)
2:30 p.m.	Cider/Coffee Break - Pre-Function and Lower Atrium Areas	2:30p.m.	Cider/Coffee Break - Pre-Function and Lower Atrium Areas
3:10 p.m.	Pricing and Calculating What a Product is Worth - <i>Tim Woods</i>	3:10 p.m.	Netting for Bird Control in Berry Crops - <i>Michael Schmidt</i>
3:40 p.m.	UK Market Report and Market Maker - <i>Lee Meyer and Bob Perry</i>	3:40 p.m.	Blackberry Production and Profit Experiences - <i>Jim Claggett</i>
4:10 p.m.	Pesticide Record Keeping - <i>Joe Masabni</i>	4:10 p.m.	Primocane Fruiting Blackberry Trial Results - <i>Kirk Pomper</i>

WHO'S WHO

Stacia Alford, Grape and Wine Marketing Specialist, Kentucky Grape and Wine Council, Office of Ag Marketing and Promotion, KY Dept. of Ag., Frankfort, KY

Zeldon Angel, Grower, Winchester, KY

Darold Akridge, Bullitt County Extension Agent for Agriculture and Natural Resources, Shepherdsville, KY

Dr. Doug Archbold, Teaching and Research, Dept. of Horticulture, University of Kentucky, Lexington, KY

Dr. Ric Bessin, Extension Entomologist, Dept. of Entomology, University of Kentucky, Lexington, KY

Dr. Michael Bomford, Organic Project Leader, Atwood Research Facility, Kentucky State University, Frankfort, KY

John Brainard, Grower, West Somerset, KY

Kristen Branscum, Tourism Development Director, Dept. of Tourism, Capital Plaza Tower, Frankfort, KY

John Carpenter, Jr., Bryant Distributing Co., Inc., Wholesale Wine Spirits, Lexington, KY

Joe Carucci, Saxophone, U.K. Jazz Cats, Lexington, KY

Butch Case, Grower, Cynthiana, KY

Jim Claggett, Grower, Princeton, KY

Dr. Tim Coolong, Extension Vegetable Specialist, Dept. of Horticulture, University of Kentucky, Lexington, KY

Dr. Tom Cottrell, Extension Enologist, Dept. of Horticulture, University of Kentucky, Lexington, KY

Jeff Dabbelt, Manager, Lexington Farmers' Market, Lexington, KY

Matt Davidson, Bass, U.K. Jazz Cats, Lexington, KY

Jamie Dockery, Fayette County Extension Agent for Horticulture, Lexington, KY

Dr. Patricia Dillon, Cat's Cradle Design, Website Design and Consulting, Lexington, KY

Janet Eaton, Kentucky Dept. of Agriculture, Division of Markets, Frankfort, KY

Jerry Eye, Grower, Bloomfield, KY

Maurice Fegenbush, President, Kentucky State Horticultural Society, Fegenbush Farms, Bloomfield, KY

Michael Fitzgerald, Organic Program Coordinator, Division of Value Added Plant Production, KY Dept. of Ag., Frankfort, KY

Courtney Flood, Extension Associate, Vegetable and Fruit Crops, Dept. of Horticulture, University of Kentucky, Research & Education Center, Princeton, KY

Dr. Robert Geneve, Teaching and Research, Dept. of Horticulture, University of Kentucky, Lexington, KY

Joe Hall, Grower, Elk Creek Vineyards, Owenton, KY

Derrick Hammons, Graduate Student, Dept. of Entomology, University of Kentucky, Lexington, KY

Dr. John Hartman, Extension Plant Pathologist, Dept. of Plant Pathology, University of Kentucky, Lexington, KY

Dr. Jimmy Henning, Associate Dean for Extension, Director, Cooperative Extension Service, University of Kentucky, Lexington, KY

Nathan Howard, Daviess County Extension Associate, Vegetable Crops, Owensboro, KY

Nathan Howell, Hart County Extension Associate, Vegetable Crops, Munfordville, KY

Dr. Dewayne Ingram, Chair, Dept. of Horticulture, University of Kentucky, Lexington, KY

Kelly Jackson, Christian County Extension Agent for Horticulture, Hopkinsville, KY

Dr. Terry Jones, Extension Horticulturist, Dept. of Horticulture, University of Kentucky, Robinson Station, Jackson, KY

Read Jordon, Risk Management Agency, USDA RMA, Jackson RO, Flowood, MS

Bob and Ann Karsner, Growers, Horseshoe Bend Vineyards, Willisburg, KY

Marcinda Kester, Agricultural Program Specialist, USDA Farm Service Agency, Lexington, KY

Jeff Kindhart, Senior Research Specialist, Dixon Springs Agricultural Center, Simpson, IL

Bruce Kunze, Grower, Utica, KY

Dr. Kaan Kurtural, Extension Viticulturist, Dept. of Horticulture, University of Kentucky, Lexington, KY

Lowell and Kathrine Land, Growers, Acres of Land Winery, Richmond, KY

Derek Law, Research Support Staff, Dept. of Horticulture, University of Kentucky, Lexington, KY

Larry Leap, Grower, Lost Heritage Vineyards, Alexandria, KY

WHO'S WHO

Dr. Dave Lockwood, Extension Fruit Specialist, Dept. of Plant and Soil Science, University of Tennessee, Knoxville, TN

Dr. Joe Masabni, Extension Fruit and Vegetable Specialist, Dept. of Horticulture, University of Kentucky, Research & Education Center, Princeton, KY

Ron and Linda McMaine, Growers, McMaine's Riverhaven Farm, Salvisa, KY

Dr. Lee Meyer, Extension Livestock and Meat Marketing Specialist, Dept. of Agricultural Economics, University of Kentucky, Lexington, KY

Dennis Morgeson, Washington County Extension Agent for Horticulture, Springfield, KY

Brandon O'Daniel, Graduate Student, Dept. of Horticulture, University of Kentucky, Lexington, KY

Ralph Packard, Grower, Misty Meadows Farm, Paynesville, KY

Rachael Peake, Owner, Capital Cellars, Frankfort, KY

Bob Perry, Food System Coordinator, University of Kentucky, Lexington, KY

Kirk Pomper, Principal Investigator of Horticulture, Curator, USDA-National Clonal Germplasm Repository for Pawpaw, Kentucky State University, Frankfort, KY

Mark Reed, Food Manufacturing Section Supervisor, Kentucky Food Safety Branch HS1CF, Health Services Bldg, Frankfort, KY

Eric Ringo, Grower, Long Lick Farm Winery, Willisburg, KY

Phil Robb, Drums, U.K. Jazz Cats, Lexington, KY

Michael Schmidt, Spec Trellising, Ivyland, PA

Dr. Kenny Seebold, Extension Plant Pathologist, Dept. of Plant Pathology, University of Kentucky, Lexington, KY

Bonnie Sigmon, Extension Associate, Vegetable Production, Dept. of Horticulture, Laurel County Extension Office, London, KY

Chris Smigell, Small Fruit and Vegetable Extension Associate, University of Kentucky, Lexington, KY

Chuck Smith, President Kentucky Vineyard Society, Smith Berry Winery, New Castle, KY

Robbie Smith, Nelson County Extension Agent for Horticulture, Frankfort, KY

Dave Spalding, Vegetable Extension Associate, Dept. of Horticulture, University of Kentucky, Lexington, KY

Maury Sparrow, Grower, Equus Run Vineyards, Midway, KY

Mac Stone, Division Director, Division of Value Added Plant Production, Kentucky Dept. of Agriculture, Frankfort, KY

Robert Stone, President, Kentucky Vegetable Growers Association, Paris, KY

Dr. John Strang, Extension Fruit and Vegetable Specialist, Dept. of Horticulture, University of Kentucky, Lexington, KY

Neil Vasilakes, Grower, Wildside Vines, Versailles, KY

Dr. Paul Vincelli, Extension Plant Pathologist, Dept. of Plant Pathology, University of Kentucky, Lexington, KY

Dr. Richard Warner, Extension Soil and Water Specialist, Dept. of Biosystems and Agricultural Engineering, University of Kentucky, Lexington, KY

Erik Walles, Grower, Berries at Bryan Station, Lexington, KY

Dennis Walter, Grower, Stone Brook Winery, Melbourne, KY

Ross Whitaker, Guitar, U.K. Jazz Cats, Lexington, KY

Dr. Wayne Wilcox, Research and Extension Fruit Pathologist, Dept. of Plant Pathology, Cornell University, NY State Agr. Expt. Sta., Geneva, NY

John Wilhoit, Extension Specialty Crop Mechanization Specialist, Dept. of Biosystems and Agricultural Engineering, University of Kentucky, Lexington, KY

Sara Williamson, Marketing Specialist, Division of Value Added Plant Production, Kentucky Dept. of Agriculture, Frankfort, KY

Patsy Wilson, Graduate Student, Dept. of Horticulture, University of Kentucky, Lexington, KY

Donna Winchell, Ohio Grape and Wine Industries, Geneva, OH

Dwight Wolfe, Research Specialist, Dept. of Horticulture, University of Kentucky, Research & Education Center, Princeton, KY

Dr. Tim Woods, Agricultural Economics Extension Specialist, Dept. of Agricultural Economics, University of Kentucky, Lexington, KY

Dr. Annette Wszelaki, Extension Vegetable Specialist, Dept. of Plant and Soil Science, University of Tennessee, Knoxville, TN

Dr. Stephen Workman, Bioenvironmental Engineering, Dept. of Biosystems and Agricultural Engineering, University of Kentucky, Lexington, KY

Stephen Yates, Director of Agrotourism, Kentucky Dept. of Agriculture, Dept. of Tourism, Frankfort, KY

Exhibitors

Ag Connections
1576 Killdeer Trail
Murray, KY 42071
270-435-4369

Arysta Lifescience
5901 Redbank Road
Galena, OH 43021
614-895-9334

BDI Machinery Sales Co.
430 E. Main Street
Macungie, PA 18062
800-605-7898

Bunton Seed Co.
939 E. Jefferson St.
Louisville, KY 40206
502-584-0136

Continental Industries, Inc.
P.O. Box 865
Shepherdsville, KY 40165
502-543-2600

Creech Services, Inc.
4100 Heraldry Court
Lexington, KY 40513
859-753-8283

Deerfield Supplies
2885 Stringtown Rd.
Elkton, KY 42220
270-265-2425

Earth Tools
1525 Kays Branch Rd.
Owenton, KY 40359
502-484-3988

Fairview Produce Auction
955 Britmart Rd.
Elkton, KY 42220
270-885-1048

Governors Office of Agricultural
Policy
404 Ann St.
Frankfort, KY 40601
502-564-4627

Greenstar Cooperative, Inc.
12093 Lisbon Road
Greenford, OH 44422
330-533-9588

Indiana Berry & Plant Co.
5218 W 500 S.
Huntingburg, IN 47542
812-683-3055

Innovative Labeling Solutions
4000 Hamilton-Middletown Rd.
Hamilton, OH 45011
513-860-2457

Kentucky Department of Agriculture
100 Fair Oaks, 5th Floor
Frankfort, KY 40601
502-564-4983

Kentucky Farm Bureau
9201 Bunsen Parkway
Louisville, KY 40250
502-495-5106

Kentucky Irrigation Co., LLC
340 Midland Place
Lexington, KY 40505
859-254-7022

Lani Basberg Agency, LLC
12 Main Street
Shelbyville, KY 40065
502-647-6021

New Crops Center
N-318 Ag. Science North
University of Kentucky
Lexington, KY 40546
859-257-1477

Nourse Farms
41 River Rd.
South Deerfield, MA 01373
413-665-2658

Prospero Equipment Corp.
5702 Gillis Drive
San Antonio, TX 78240
210-543-2389

Rockford Packaging Supply, Inc.
10421 Northland Drive
Rockford, MI 49341
800-444-7225 or 616-866-0143

Seedway, Inc.
7250 Ruggles Ferry Pk
Knoxville, TN 37924
865-548-7333

Spec Trellising
39 Indian Dr.
Ivyland, PA 18974
800-237-4594

Stokes Seeds, Inc.
13265 Howe Rd.
Fishers, IN 46038
317-578-7906

U.A.P. Distribution, Inc.
6803 North Henderson Ford Rd.
Mooresville, IN 46158
317-831-2559

Literature Table

Krohne Plant Farms, Inc.
65295 County Rd. 342
Hartford, MI 49057
269-424-5423

2nd Floor

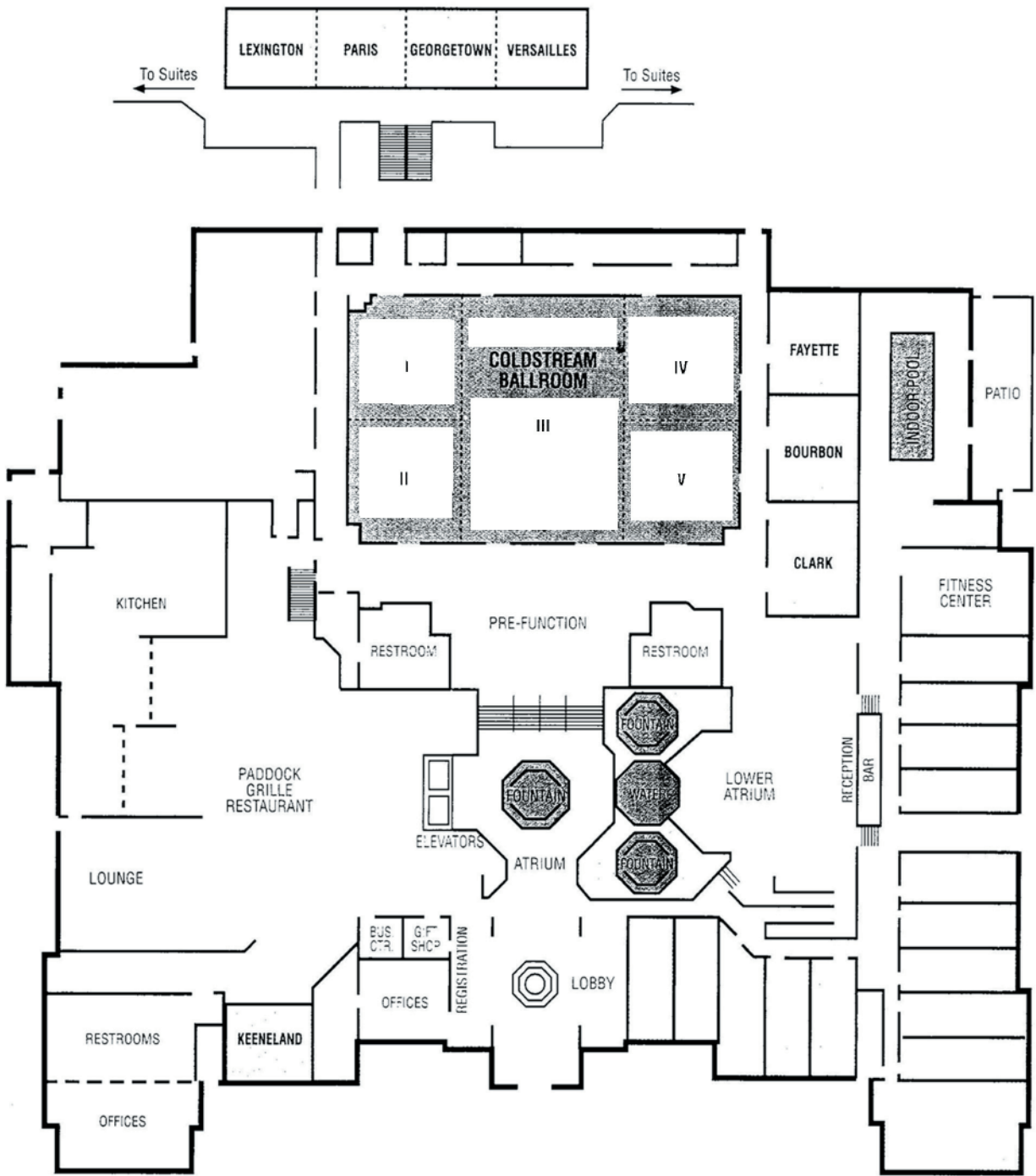

Kentucky State Horticultural Society
UK Research & Education Center
PO Box 469
Princeton KY 42445-0469

DIRECTIONS

From I-75/64: Take Exit 115 then right on to Newtown Pike. Turn right onto Aristides Blvd. at the UK Coldstream Research Campus. Hotel is on the right.
From Blue Grass Airport: Exit left on to Man O'War Blvd. to Versailles Rd. Turn right onto Versailles Rd. Take Rt. 4 New Circle Rd. north to Newtown Pike Exit North. Turn left onto Aristides Blvd. at the UK Coldstream Research Campus. Hotel is on the right.

