

A photograph of a rural landscape. In the foreground, there is a lush green field with some dark patches. In the middle ground, a white barn with a dark roof is visible on the left, partially obscured by trees. A fence runs across the field. Several dark-colored cows are grazing in the field. The background shows a line of trees under a sky with scattered white clouds.

# **Kentucky Geological Survey**

## **Marvin Blan #1**

**Wellsite and Road Construction**



**KGS Marvin Blan #1 Wellsite**

**Proposed  
Wellsite**  
(2.07 Ac)

Proposed Well  
KGS #1  
TD 8350 ft

**Leased Lands**  
(196 Ac)

**Barns**

**Cemetery**

**Blan's  
Home**





# KGS Marvin Blan #1 Test Well Drilling Location

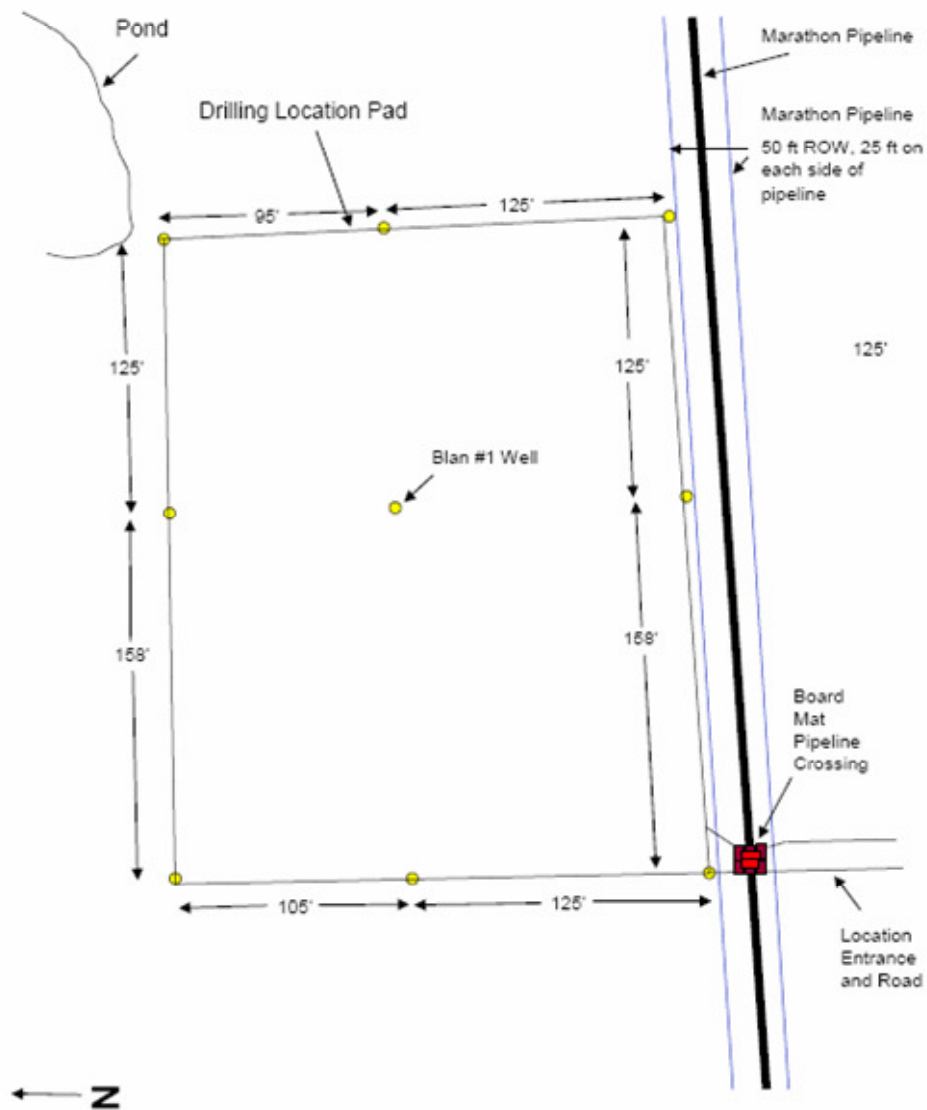

1.46 Acre wellsite



**Breaking ground for the wellsite**





Removing topsoil at the wellsite





Wellsite under construction





Well Location

Completed wellsite





Completed wellsite and topsoil storage





Entry from Sweet Road by the Blan's home





New cattle guard at Sweet Road entrance





Wellsite entrance from Sweet Road





Road construction



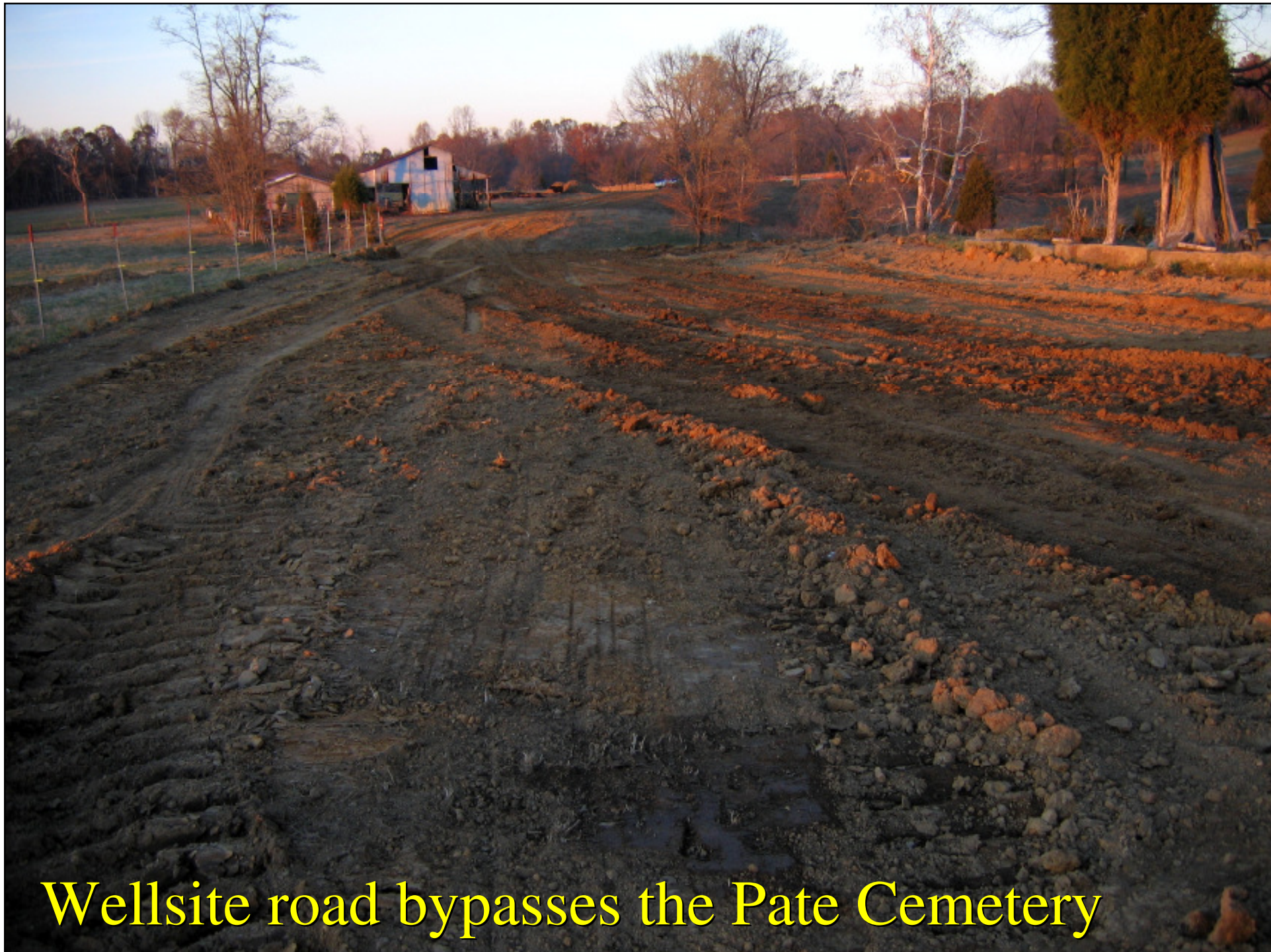

Wellsite road bypasses the Pate Cemetery





Pate Cemetery and bypass road





Road crossing and drainage culverts



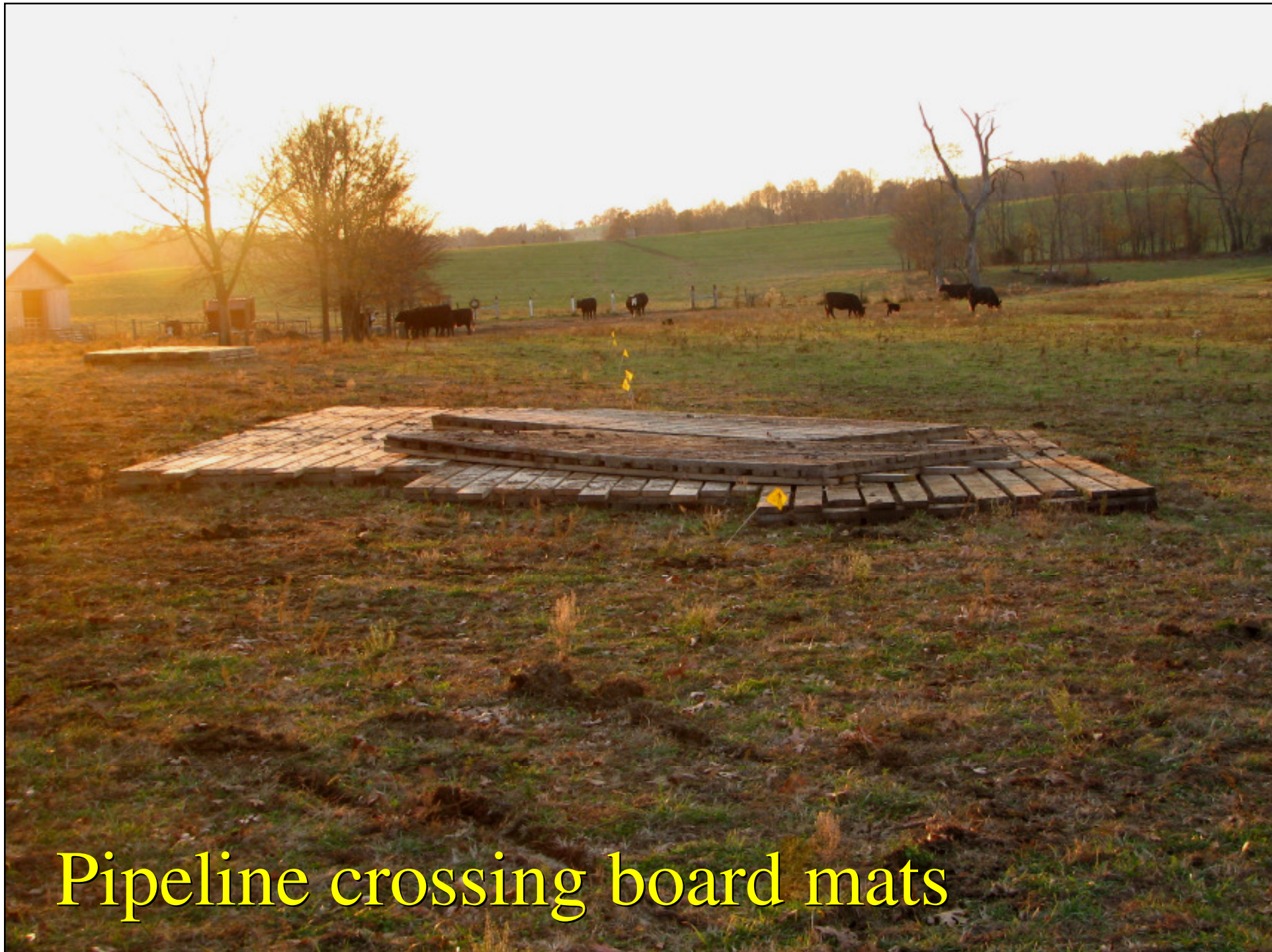

Pipeline crossing board mats





Pipeline crossing under construction





Well Location

New cattle guard at wellsite entry





Moving water and electrical lines





Splicing electrical lines