

Important: Warranty Disclaimer for Plans

For the convenience of our clientele, this website makes available conceptual plans that can be helpful in planning buildings, facilities, or other structures. They were developed over many years by engineers at Land Grant universities through the former USDA Cooperative Farm Buildings Plan Exchange. *Regardless of the original intent, these are older plans that provide conceptual information only, and are not to be considered or used as construction plans.*

These plans do not claim to represent the most current technology or the most recent construction techniques, standards, or codes. For example, over the years there have been changes in the National Design Specifications for Wood Construction, changes in the strengths and types of building materials, and changes in fasteners, among other things. Those changes, along with variations in climate, building codes, and other factors, make it imperative that professional services be utilized for your specific project. Suggested services include, but are not limited to, structural design, assurance of compliance with codes and regulations, site selection, construction supervision, and provision for utilities, waste management, and access. *These plans do not replace the need for competent design assistance in developing safe, legal, and well-functioning agricultural buildings and systems.*

Neither the University of Kentucky, the Midwest Plan Service, the United States Department of Agriculture, nor any of the cooperating Land Grant universities, warranty these plans. They are for conceptual use only and are not for use as construction plans.

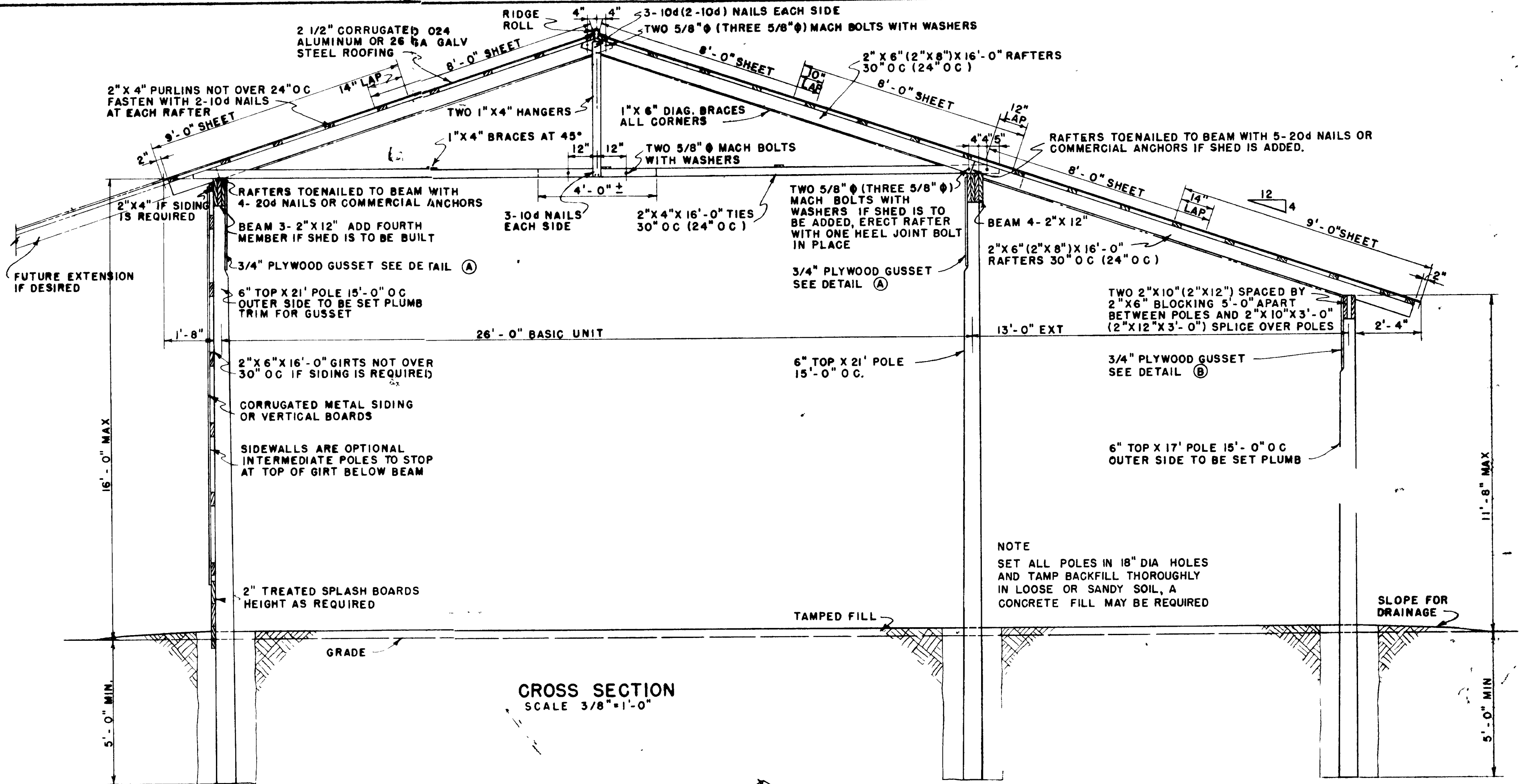

CROSS SECTION
SCALE 3/8" = 1'-0"

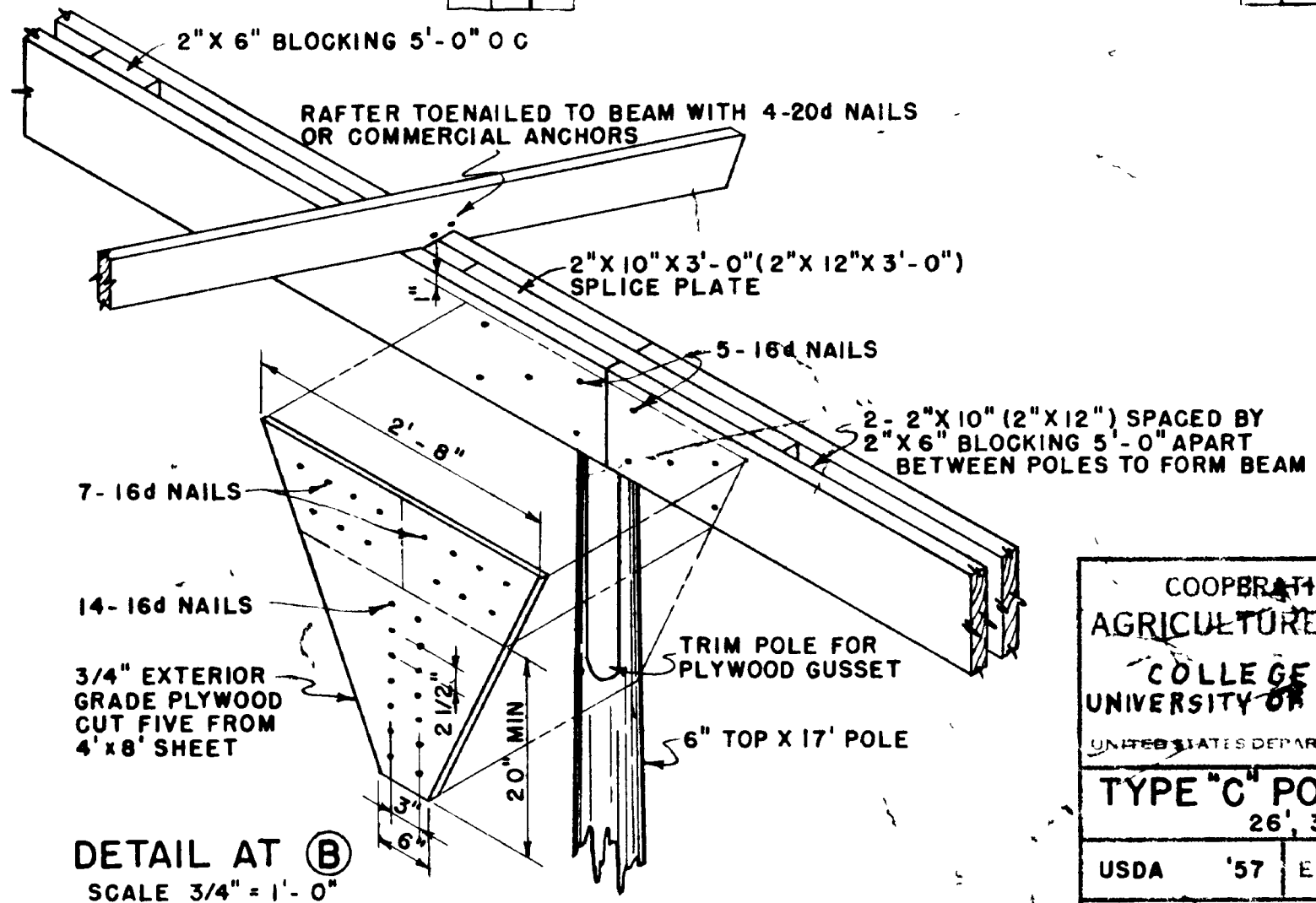
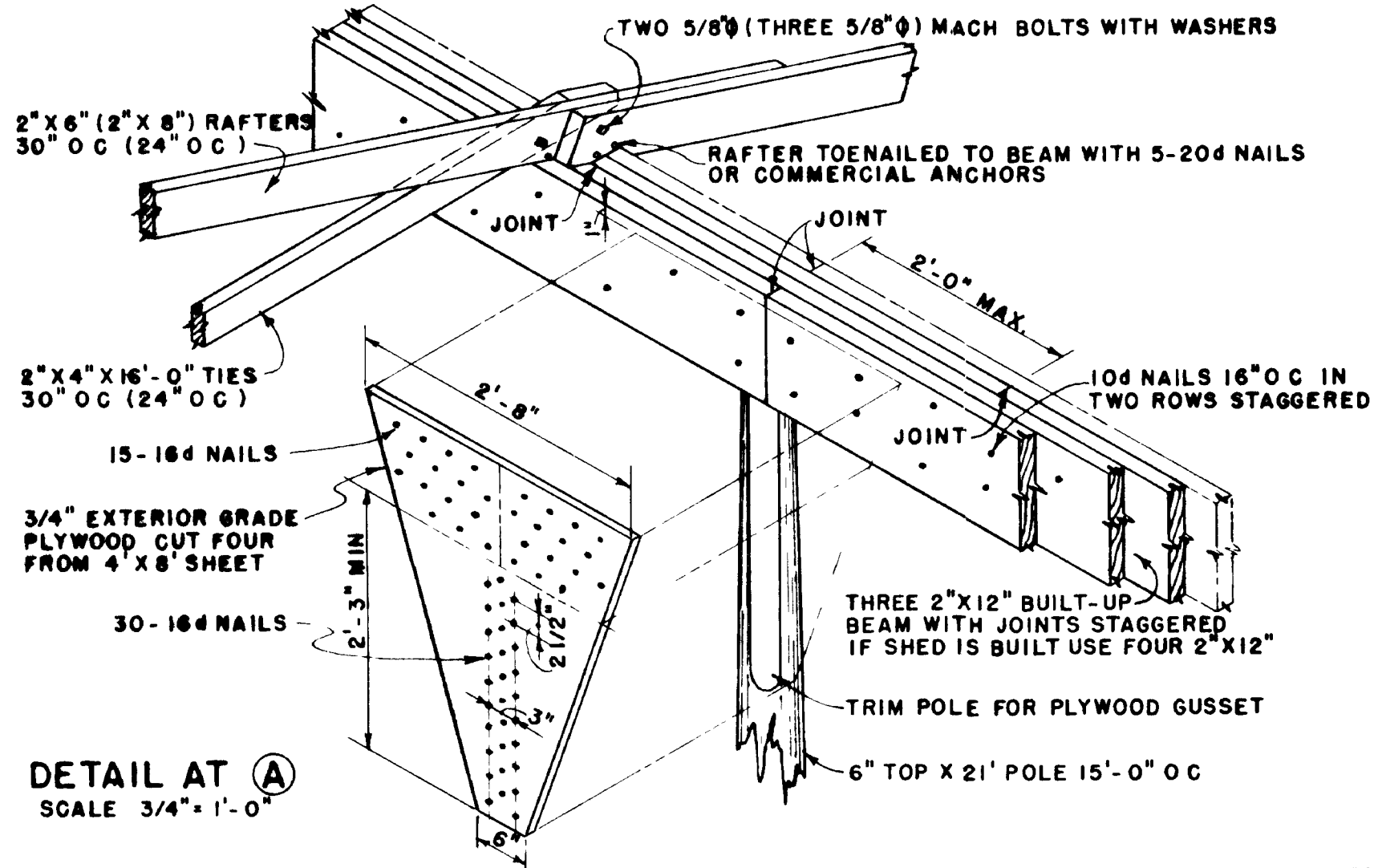

COOPERATIVE EXTENSION WORK IN
AGRICULTURE AND HOME ECONOMICS
COLLEGE OF AGRICULTURE
UNIVERSITY OF KENTUCKY, LEXINGTON, KY
AND
UNITED STATES DEPARTMENT OF AGRICULTURE COOPERATING

TYPE "C" POLE CONSTRUCTION
26', 39' OR 52' WIDTH

USDA	'57	EX	5832	SHEET 2 OF 2
------	-----	----	------	--------------

REV SWEP 1953

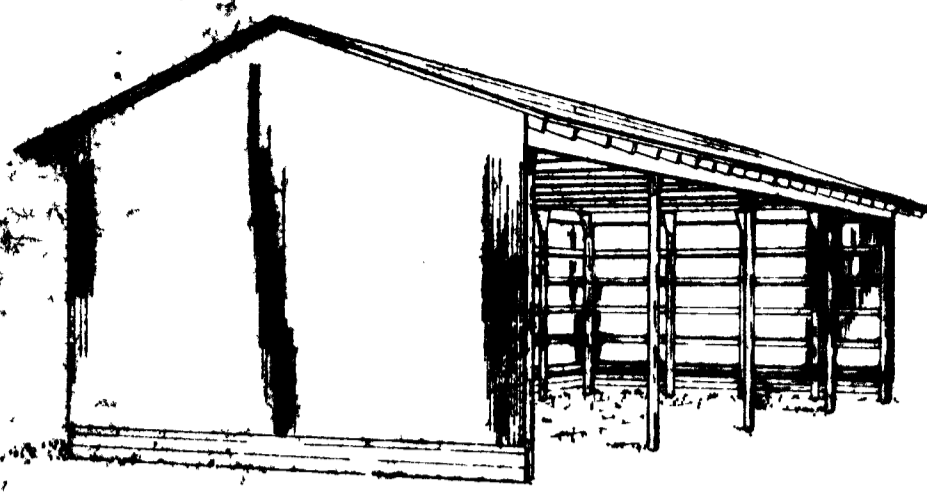

26 FOOT WIDTH
(BASIC UNIT)

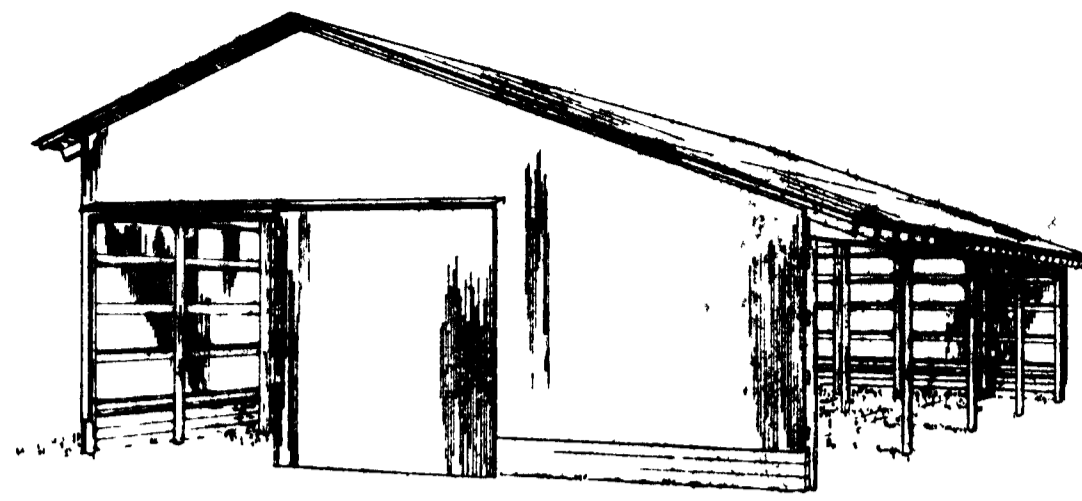

39 FOOT WIDTH

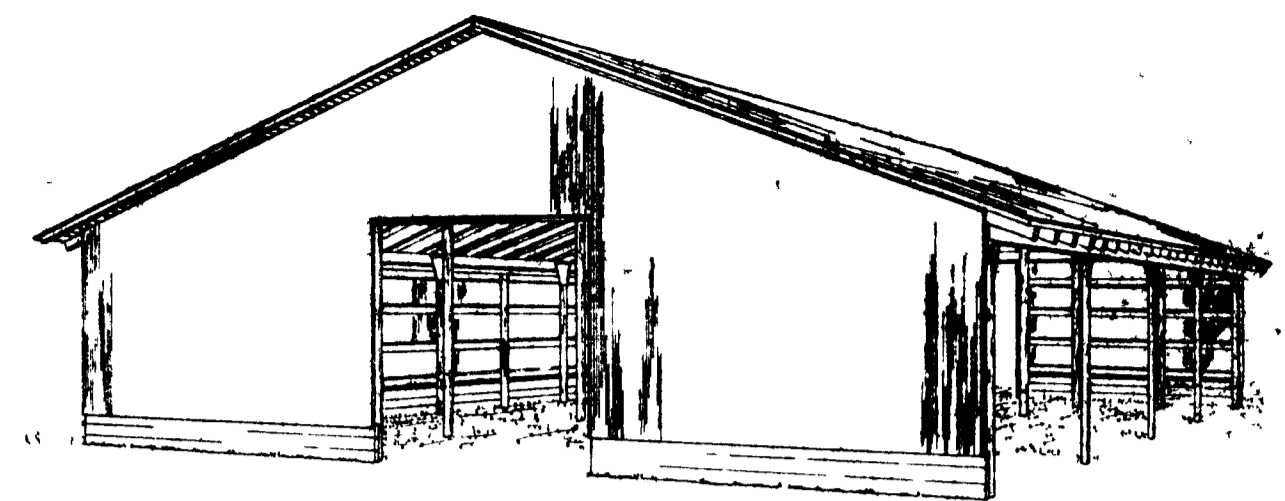

52 FOOT WIDTH

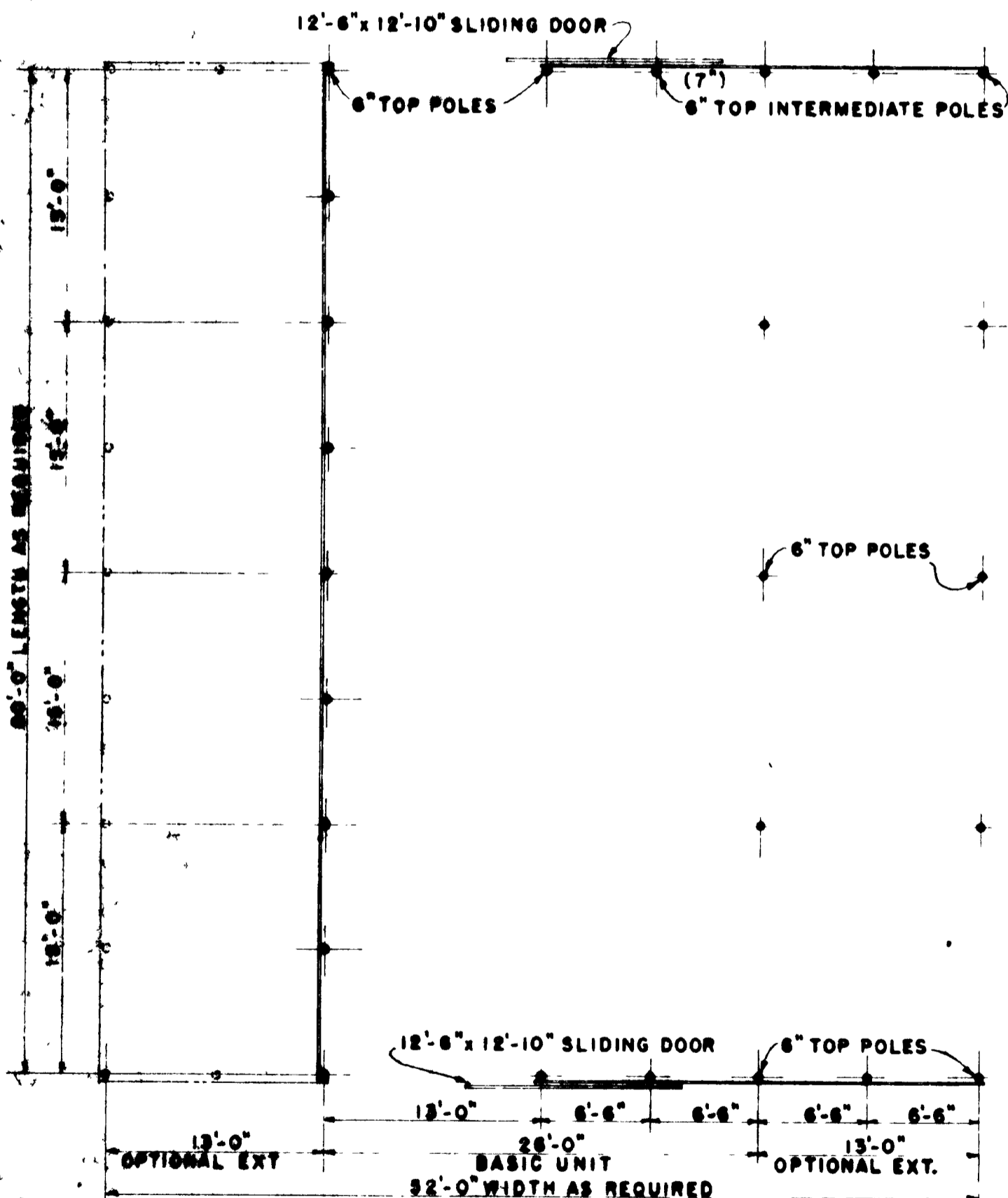

FLOOR PLAN
SCALE 1/8"=1'-0"

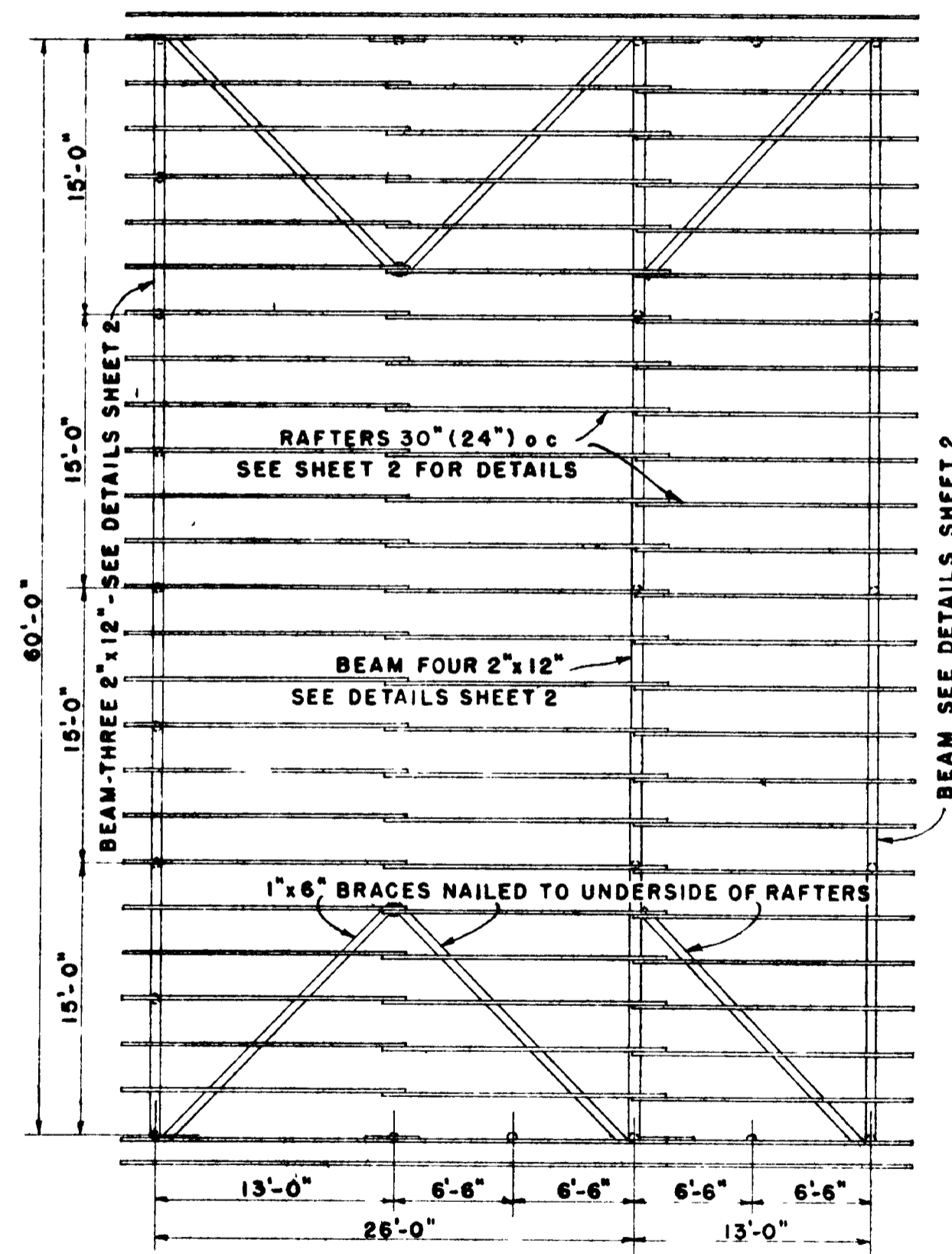

ROOF FRAMING PLAN
SCALE 1/8"=1'-0"

NOTE

LENGTH OF THE BUILDING MAY BE VARYED IN UNITS OF 15 FEET

THIS STRUCTURE IS PRIMARILY INTENDED FOR USE IN AREAS WHERE THE SNOW LOAD DOES NOT EXCEED

20 LB. PER SQUARE FOOT AND WIND DOES NOT EXCEED 88 MILES PER HOUR. IN AREAS SUBJECT TO SNOW LOADS UP TO 50 LB. PER SQUARE FOOT OR HIGHER WINDS USE THE FIGURES SHOWN IN

PARENTHESES () FOR FRAMING SIZES AND NAILS.

ALL POLES, SPLASH BOARDS AND OTHER WOOD IN CONTACT WITH THE GROUND OR MANURE TO BE TREATED

WITH PRESERVATIVE.

THE 2 1/2" CORRUGATED METAL ROOFING IS APPLIED TO 2"x4" NAILING STRIPS SPACED NOT OVER 24" APART OR AS SPECIFIED BY THE MANUFACTURER

COOPERATIVE EXTENSION WORK IN AGRICULTURE AND HOME ECONOMICS
COLLEGE OF AGRICULTURE
UNIVERSITY OF KENTUCKY, LEXINGTON, KY

AND UNITED STATES DEPARTMENT OF AGRICULTURE COOPERATING

TYPE "C" POLE CONSTRUCTION
26', 39' OR 52' WIDTH

USDA '57 EX 5832 SHEET 1 OF 2