

SIDE ELEVATION SCALE: 3/16" = 1'-0"
SHOWING ALTERNATE VENTILATOR PANELS

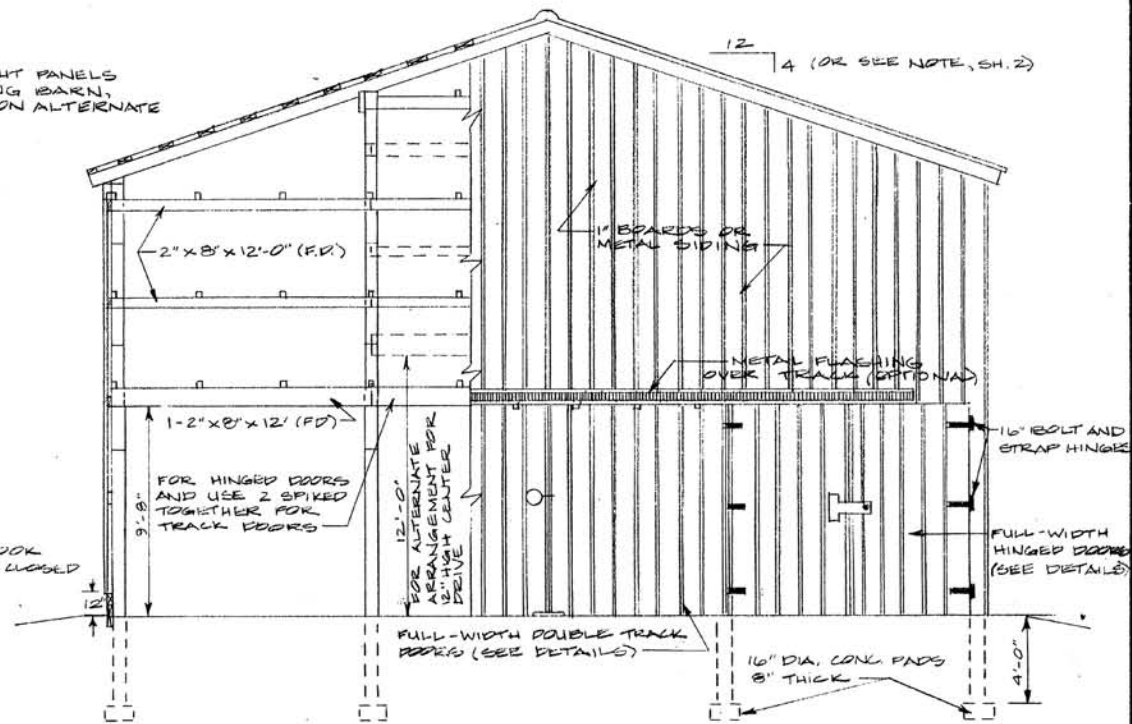

END ELEVATION SCALE: 3/16" = 1'-0"
SHOWING ALTERNATE DOOR DETAILS (FULL-WIDTH TRACK OR HINGED DOORS)

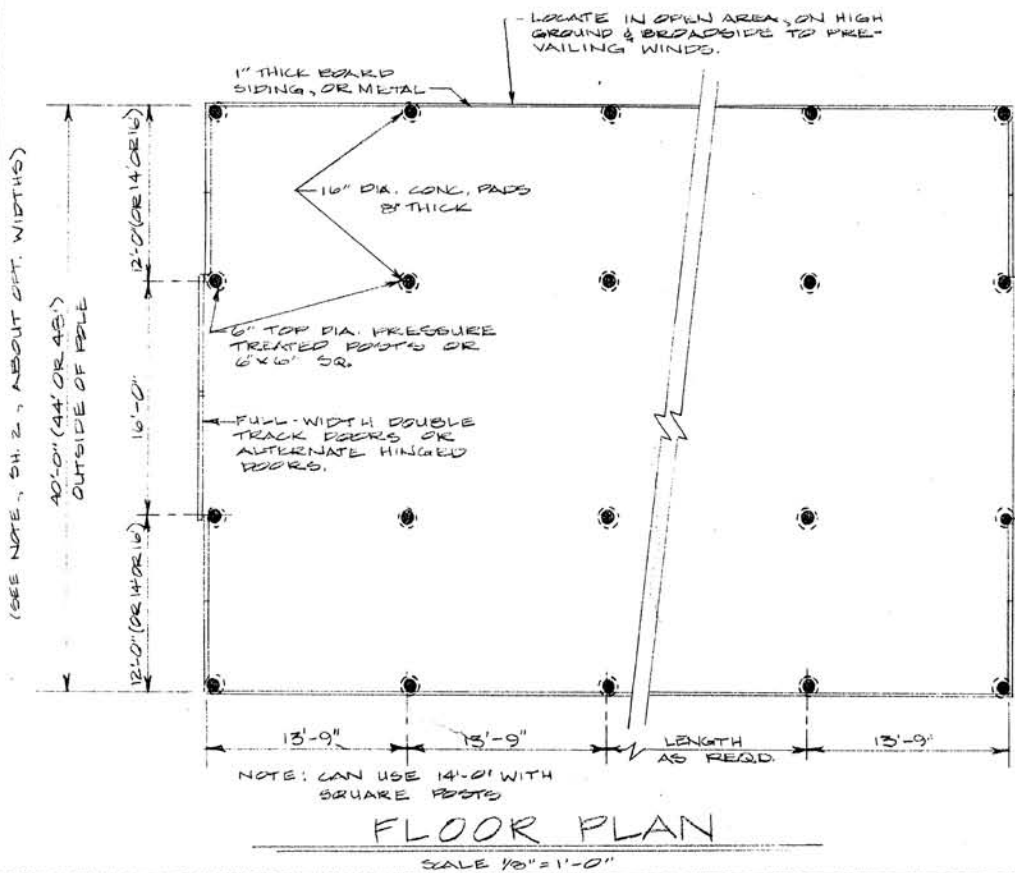

FLOOR PLAN
SCALE 1/8" = 1'-0"

NOTE: THIS PLAN SHOWS POLE-TYPE CONSTRUCTION. IF POST-CONCRETE PIER TYPE CONSTRUCTION DESIRED, OBTAIN PLAN 755-27A.

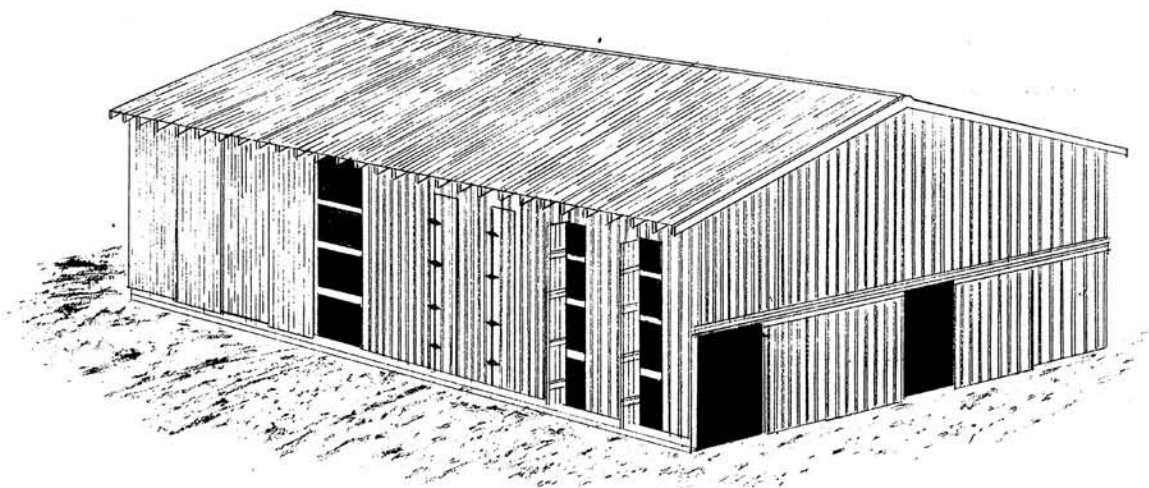

3-TIER AIR CURE BURLEY BARN 40', 44' OR 48' WIDE POLE CONSTRUCTION

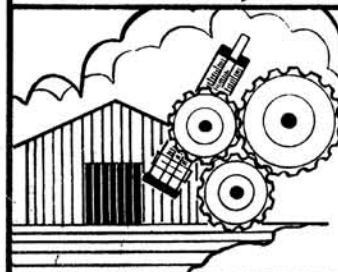

COOPERATIVE EXTENSION SERVICE
AGRICULTURE AND HOME ECONOMICS
DEPARTMENT OF AGRICULTURAL ENGINEERING
COLLEGE OF AGRICULTURE
UNIVERSITY OF KENTUCKY
AND
U.S. DEPARTMENT OF AGRICULTURE COOPERATING

DESIGNED BY: G. A. DUNCAN	SHEET 1 OF 3
CHECKED BY: G. A. DUNCAN	PLAN NUMBER
DRAWN BY: S. ELLIOTT	KY. II. 735-25A
DATE: 8-11-52	
REVISIONS: 11-55	

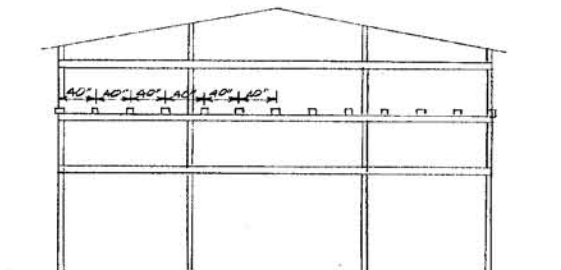

NOTE:
 SIDE DRIVEWAYS MAY BE 14' OR 16' WIDE. USE THE FOLLOWING SIZE MATERIALS:
 RAFTERS: 14' WIDE: 2X6X16 @ 2' O.C. 16' WIDE: 2X6X18 @ 2' O.C.
 BEAMS: 2X10X14' 2X12X16'
 ROOF SLOPE: AS REQ'D 4:12

NOTE:
 NARROWER TIER RAIL SPACING MAY BE USED FOR EASIER STANDING AND WORKING.

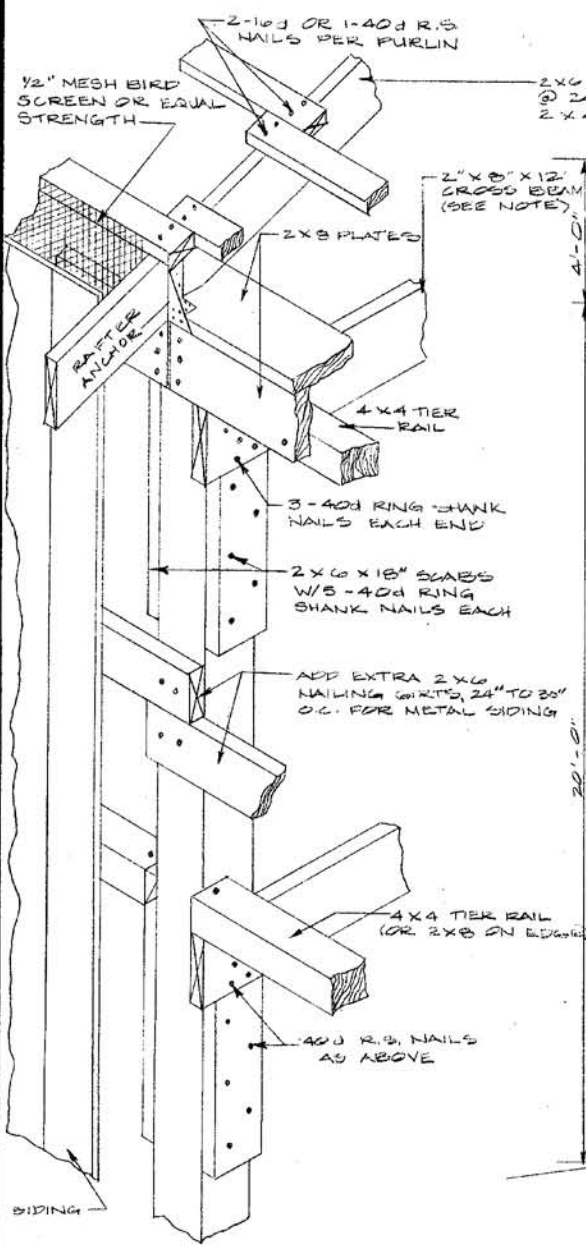

SIDEWALL POST DETAIL
 NO SCALE

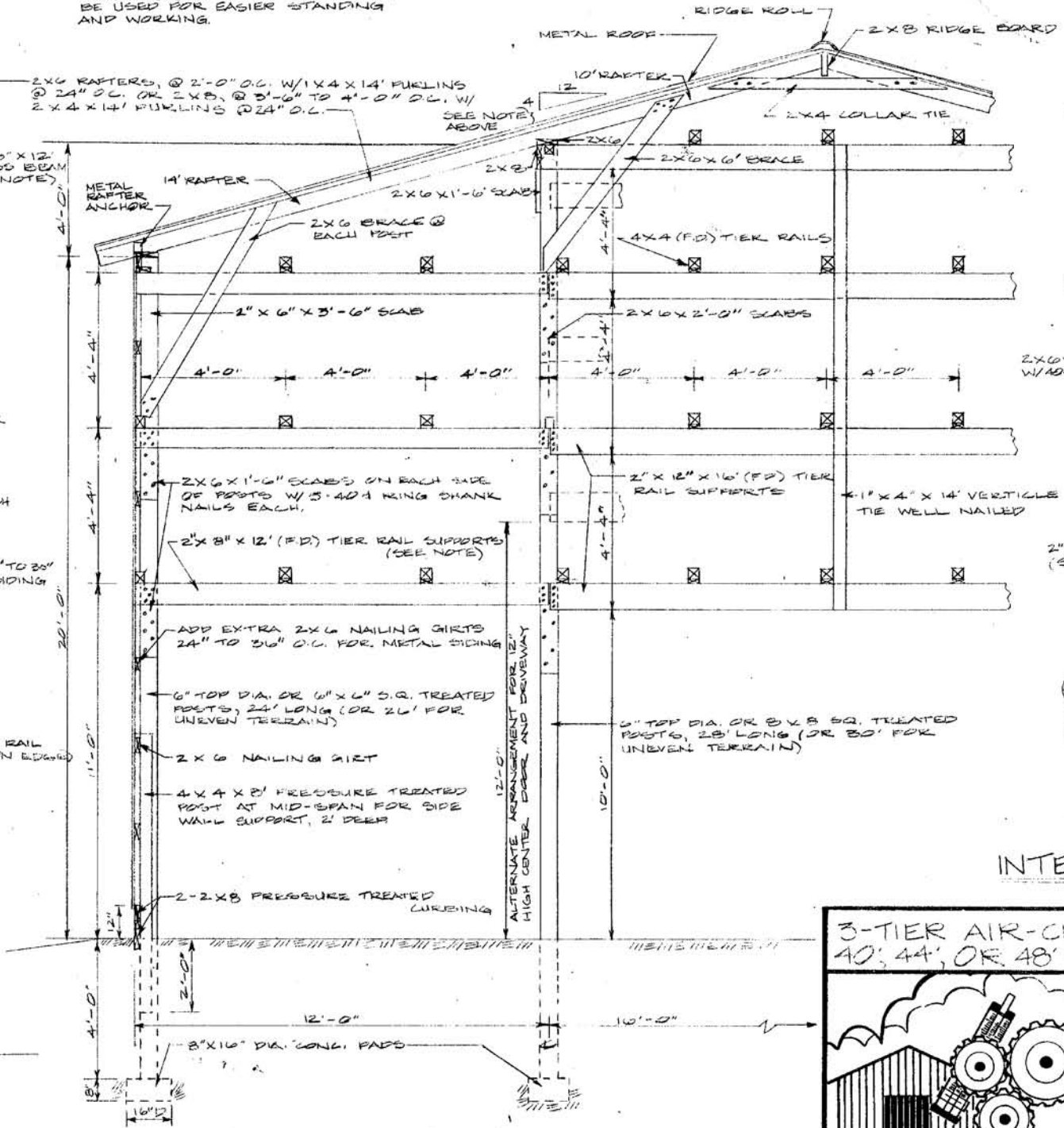

CROSS SECTION
 (NOT TO SCALE)

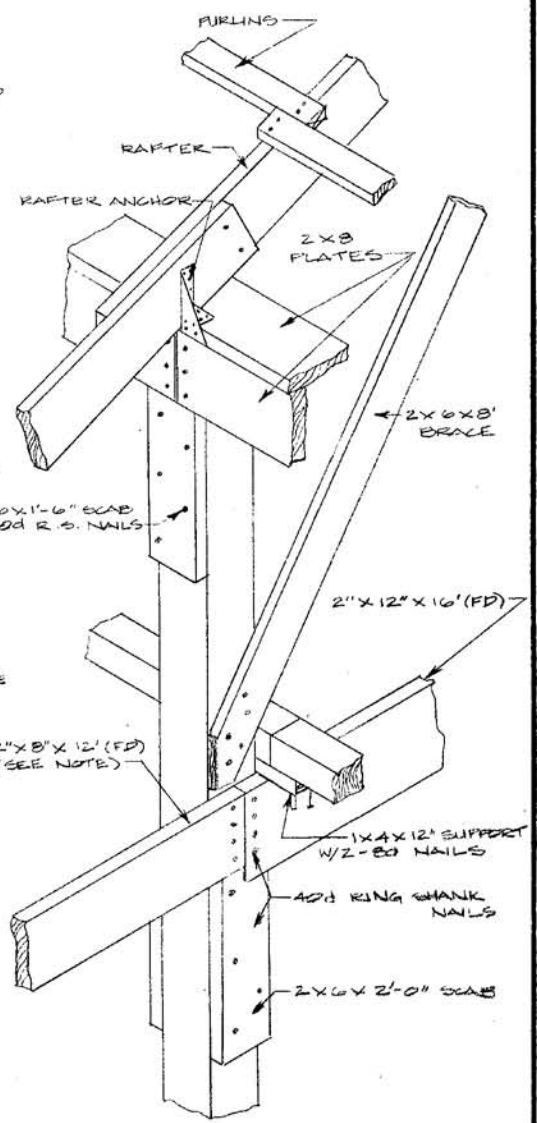

INTERIOR POST DETAIL
 (NO SCALE)

3-TIER AIR-CURE BURLEY BARN
 40', 44', OR 48' WIDE POLE CONSTRUCTION

COOPERATIVE EXTENSION SERVICE
 AGRICULTURE AND HOME ECONOMICS
 DEPARTMENT OF AGRICULTURAL ENGINEERING
 COLLEGE OF AGRICULTURE
 UNIVERSITY OF KENTUCKY
 AND
 U.S. DEPARTMENT OF AGRICULTURE COOPERATING

DESIGNED BY: G.A. DUNKAN	SHEET 2 OF 3
CHECKED BY: G.A. DUNKAN	PLAN NUMBER
DRAWN BY: S. ELLIOTT	KY. 11.735-29A
DATE: 8-71	
REVISIONS: 4-74, 1-82, 11-85	

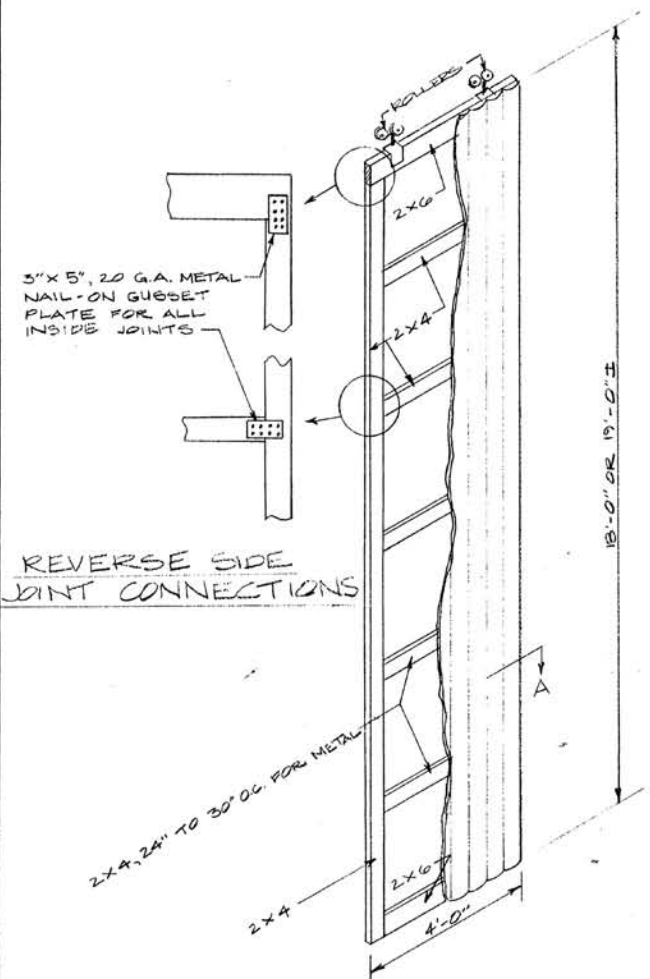

REVERSE SIDE
JOINT CONNECTIONS

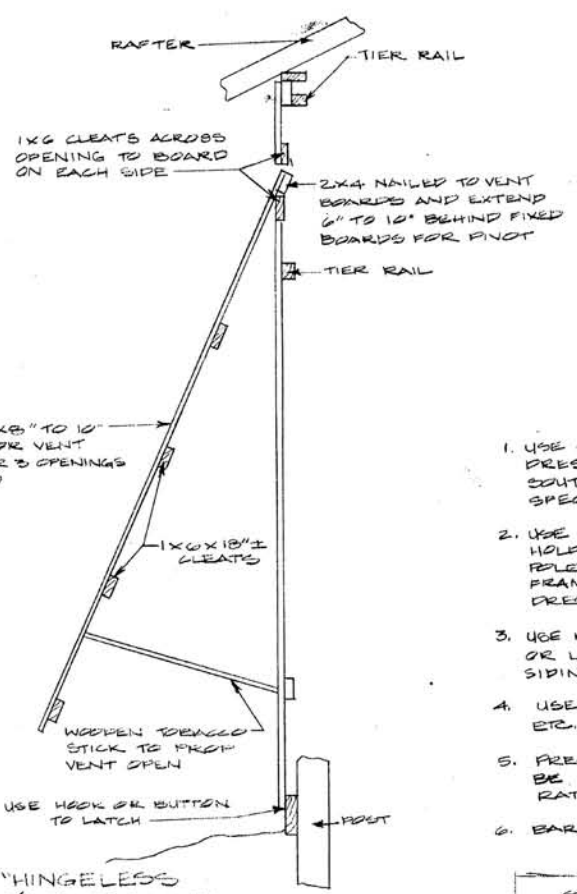

ECONOMY "HINGELESS"
SWING OUT VENT PANEL

MATERIALS AND CONSTRUCTION NOTES

1. USE GOOD QUALITY FULL DIMENSION (F.D.) ROUGH SAWN LUMBER, OR DRESSED (S&S) LUMBER OF STANDARD GRADE DOUGLAS FIR, NO. 2 SOUTHERN YELLOW PINE, EQUIVALENT OR BETTER, OF THE SIZES SPECIFIED ON THE PLANS.
2. USE RING SHANK OR SCREW SHANK POLE BARN NAILS FOR SUPERIOR HOLDING STRENGTH, ESPECIALLY FOR ALL CONNECTIONS TO PRES. TRTD. POLES AND ALL SOFTWOOD LUMBER NAILING. USE 40d (5") NAILS FOR FRAMING - TO PRES. TRTD. POLE JOINTS; USE 12d OR 16d FOR ALL DRESSED (S&S) LUMBER FRAMING, OR 16d (3 1/2") FOR LUMBER FRAMING.
3. USE RING SHANK OR SCREW SHANK ROOFING NAILS WITH NEOPRENE WASHER OR LEAD-UNDER-HEAD PER MFGRS. SPECS. FOR ALL METAL ROOFING OR SIDING ATTACHMENT.
4. USE HEAVY-DUTY DOUBLE TRACK WITH ADEQUATE HANGERS, ROLLERS, ETC., FOR ENTRANCE DOORS.
5. PRESERVATIVE TREATED POLES, POSTS, AND CHIRING BOARDS SHALL BE CREOSOTE, PENTA, OR COMPOSE K-33 TREATED TO RETENTION RATE SPECIFIED BY A.W.P.A. FOR GROUND CONTACT USE.
6. BARN CAPACITY (ACRES PER 13'-9" BENT, 30 TIER SPACES/BENT)

PLANTING DENSITY	6 PLANTS/STICKS				5 PLANTS/STICKS			
	10"	9"	8"	7"	9"	8"	7"	6"
8,500	.17	.19	.21	.24	.19	.21	.24	.28
9,250	.33	.37	.41	.47	.31	.35	.39	.46
10,000	.51	.54	.58	.63	.50	.54	.58	.65

METAL-COVERED SIDE WALL VENT DOORS ON TRACK

SCALE: 3/8" = 1'-0"

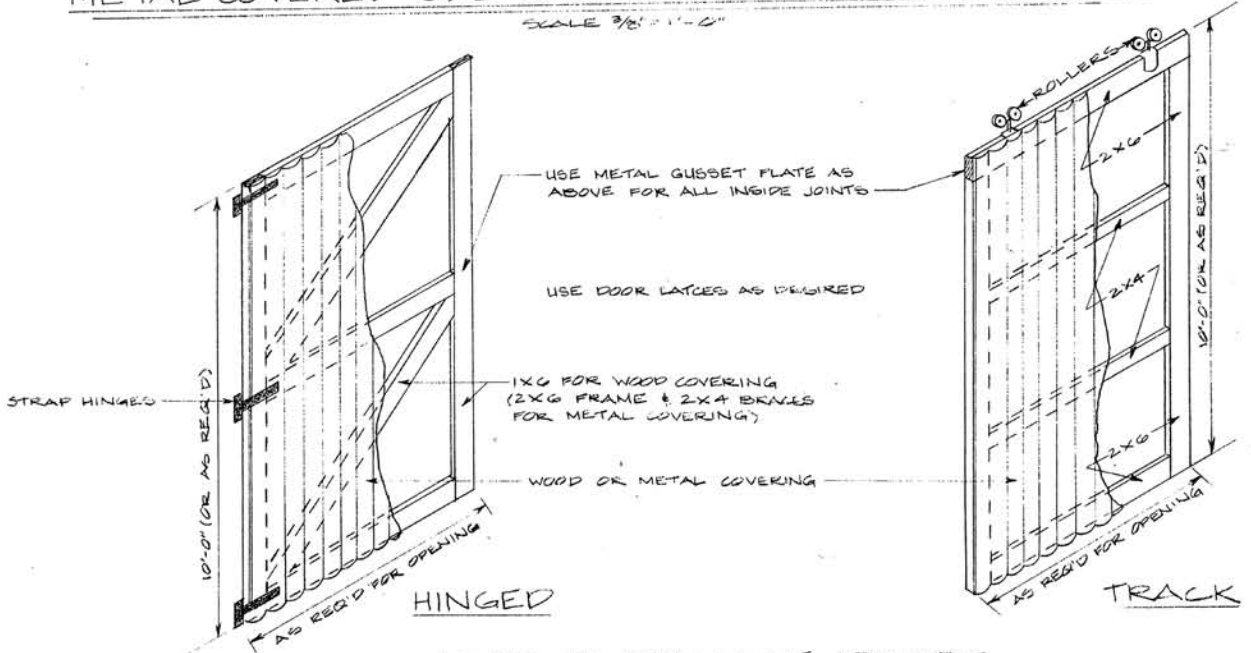

END ENTRANCE DOORS

SCALE: 3/8" = 1'-0"

7. FOR FURTHER INFORMATION ON TOBACCO BARN TYPES AND NEW METHODS OF HARVESTING AND HOUSING TOBACCO, SEE PUBLICATION ID 41, "TOBACCO HANDBOOK" AND OTHER AVAILABLE LITERATURE.

3'-TIER AIR-CURE BURLEY BARN
40', 44', OR 48' WIDE POLE CONSTRUCTION

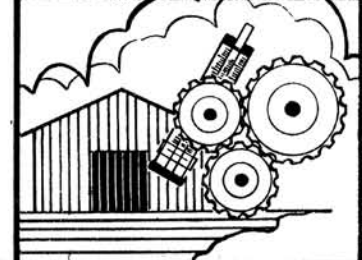

COOPERATIVE EXTENSION SERVICE
AGRICULTURE AND HOME ECONOMICS
DEPARTMENT OF AGRICULTURAL ENGINEERING
COLLEGE OF AGRICULTURE
UNIVERSITY OF KENTUCKY
AND
U.S. DEPARTMENT OF AGRICULTURE COOPERATING

DESIGNED BY: G. A. DUNCAN
CHECKED BY: G. A. DUNCAN
DRAWN BY: S. ELLIOTT
DATE: 2-71, 4-81, 1-82
REVISIONS: 12-83

SHEET 3 OF 3
PLAN NUMBER
KY. 11.735-29A