

## **Important: Warranty Disclaimer for Plans**

For the convenience of our clientele, this website makes available conceptual plans that can be helpful in planning buildings, facilities, or other structures. They were developed over many years by engineers at Land Grant universities through the former USDA Cooperative Farm Buildings Plan Exchange. *Regardless of the original intent, these are older plans that provide conceptual information only, and are not to be considered or used as construction plans.*

These plans do not claim to represent the most current technology or the most recent construction techniques, standards, or codes. For example, over the years there have been changes in the National Design Specifications for Wood Construction, changes in the strengths and types of building materials, and changes in fasteners, among other things. Those changes, along with variations in climate, building codes, and other factors, make it imperative that professional services be utilized for your specific project. Suggested services include, but are not limited to, structural design, assurance of compliance with codes and regulations, site selection, construction supervision, and provision for utilities, waste management, and access. *These plans do not replace the need for competent design assistance in developing safe, legal, and well-functioning agricultural buildings and systems.*

**Neither the University of Kentucky, the Midwest Plan Service, the United States Department of Agriculture, nor any of the cooperating Land Grant universities, warranty these plans. They are for conceptual use only and are not for use as construction plans.**

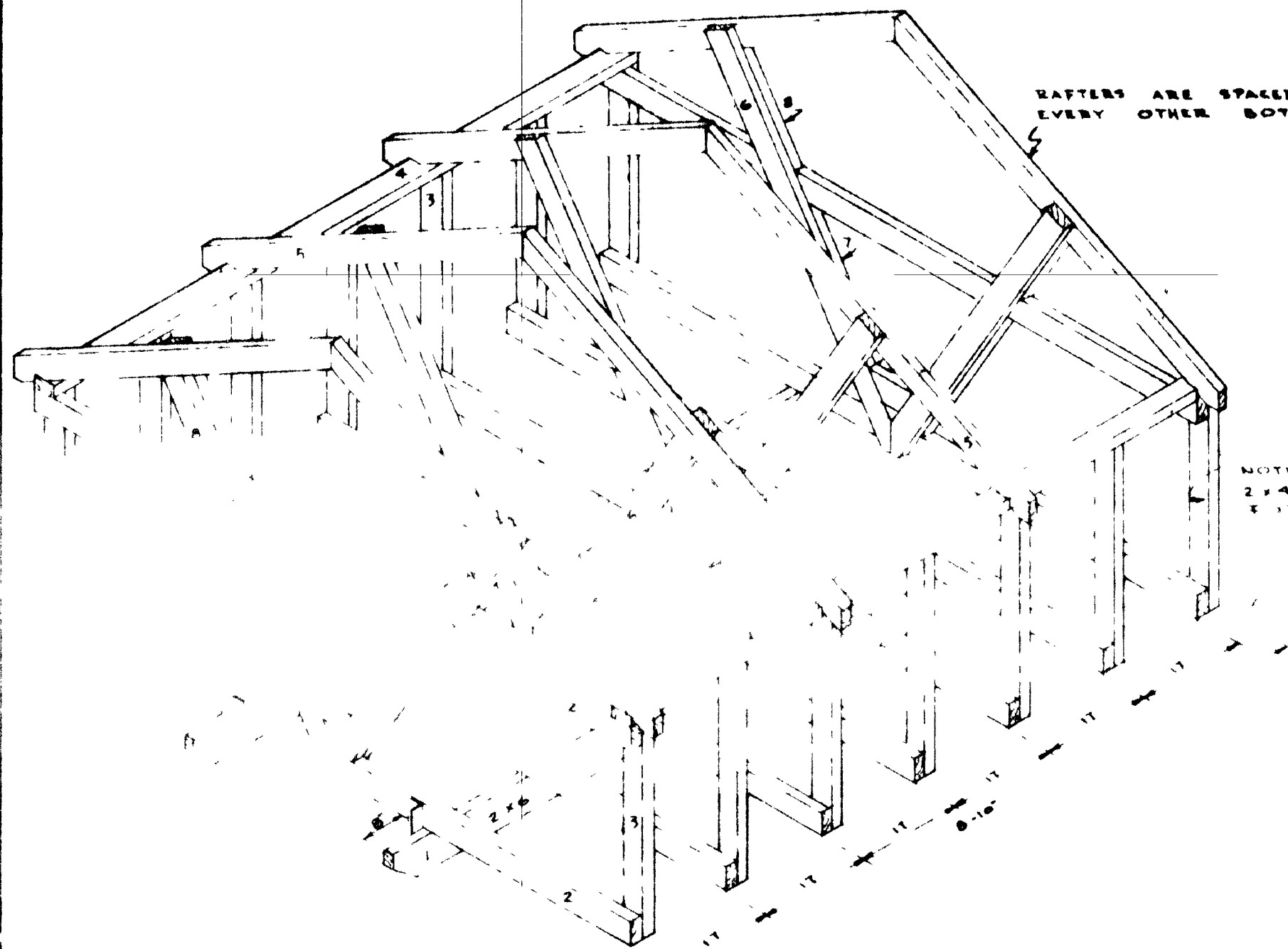

RAFTERS ARE SPACED DIRECTLY OVER EVERY OTHER BOTTOM JOIST

NOTE ALL FRAMING IS 2x4 EXCEPT 2x6 FOR RUNNER

DETAIL OF FRAMING

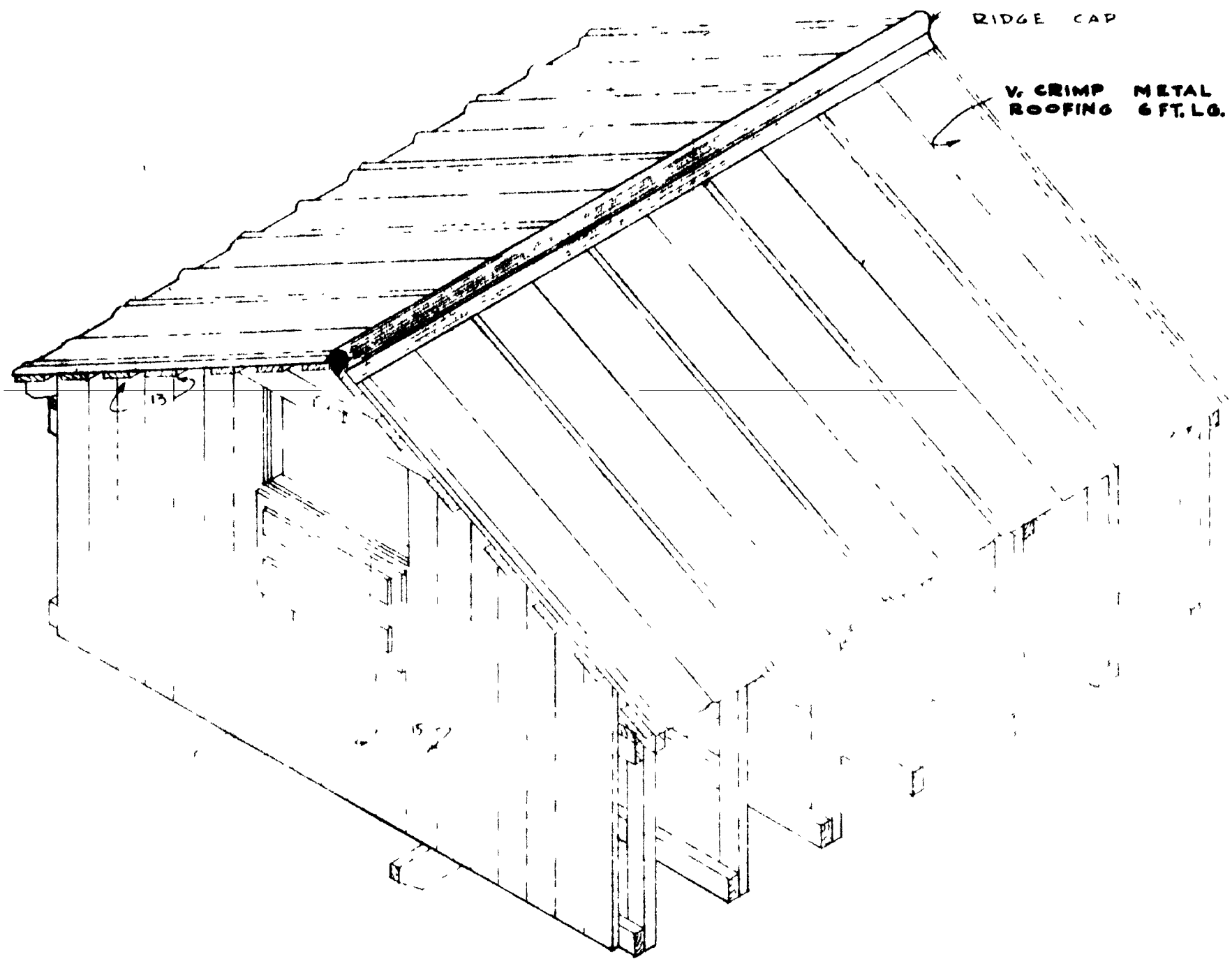

RIDGE CAP

V-CRIMP METAL ROOFING 6 FT. LG.

COMPLETE VIEW OF FEEDER

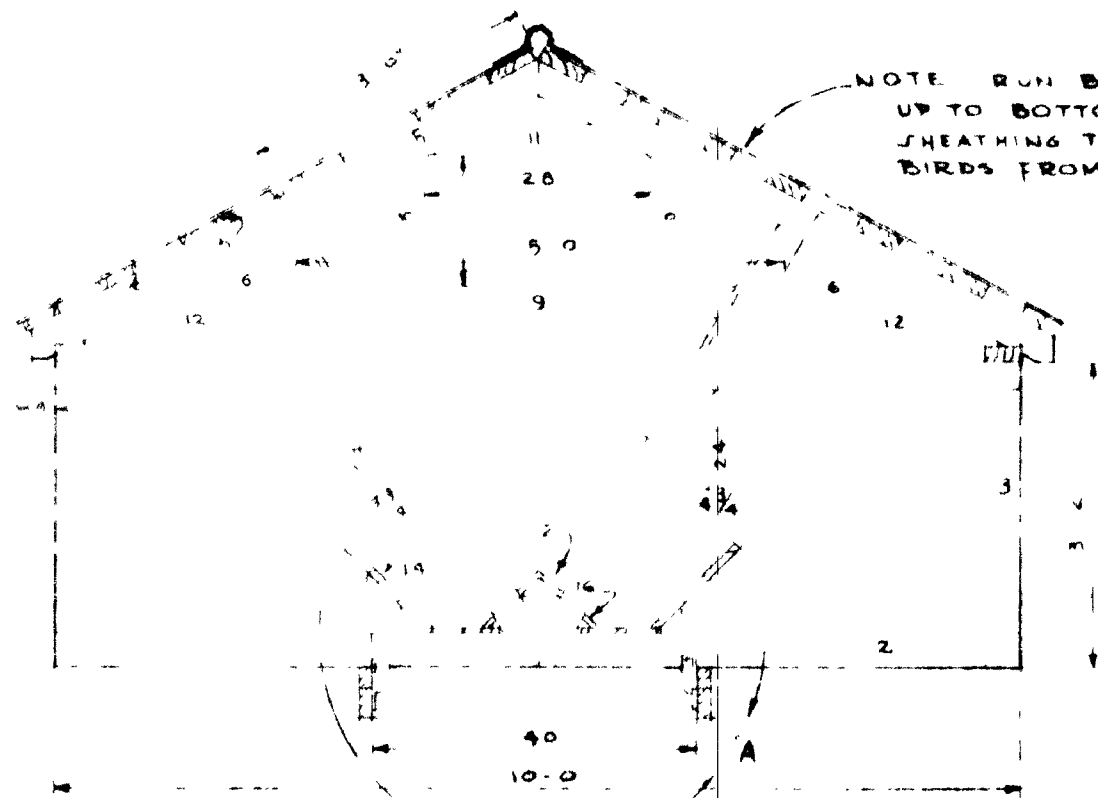

NOTE RUN BIN SIDES UP TO BOTTOM OF SHEATHING TO PREVENT BIRDS FROM ENTERING

END VIEW SHOWING FRAMING

BILL OF MATERIALS		
PART NO	LUMBER & SIZE OF MATERIAL	STANDARD STOCK TO CUT MATERIAL FROM
1	2 PCS - 2x6x10-0	2 - 2x6x10-0
2	9 PCS - 2x4x10-0	9 - 2x4x10-0
3	14 PCS - 2x4x3-2'	5 - 2x4x10-0
4	2 PCS - 2x4x8-10'	2 - 2x4x10-0
5	8 PCS - 2x4x6-0'	4 - 2x4x12-0
6	8 PCS - 2x4x5-8	4 - 2x4x12-0
7	4 PCS - 2x4x3-6'	2 - 2x4x8-0'
8	4 PCS - 2x4x1-0	USE PCS REMAINING FROM CUT NO 7
9	2 PCS - 2x4x4-0'	1 - 2x4x8-0
10	4 PCS - 2x4x1-4'	1 - 2x4x10-0"
11	2 PCS - 2x4x2-4	USE PCS REMAINING FROM CUT NO 10
12	6 PCS - 2x4x10	USE PCS REMAINING FROM CUT NO 3&4
13	14 PCS - 1x4x12-0	14 - 1x4x12-0
14	2 PCS - 1x8x10-0"	2 - 1x8x10-0"
	2 PCS - 1x6x10-0"	2 - 1x6x10-0"
15	250 PFT 1 1/2" T & G 10# 8D NAILS 16 3/8" CARRIAGE BOLTS 2 1/2" LONG 5# 16D COMMON NAILS	
16	2 PCS - 1x10x10-0	2 PCS - 1x10x10-0"
17	2x2 ANGLE IRON - 9 LONG FOR BRACING RUNNERS 26 3/8" CARRIAGE BOLTS 4 1/4 LONG 26 3/8" FLAT WASHERS	

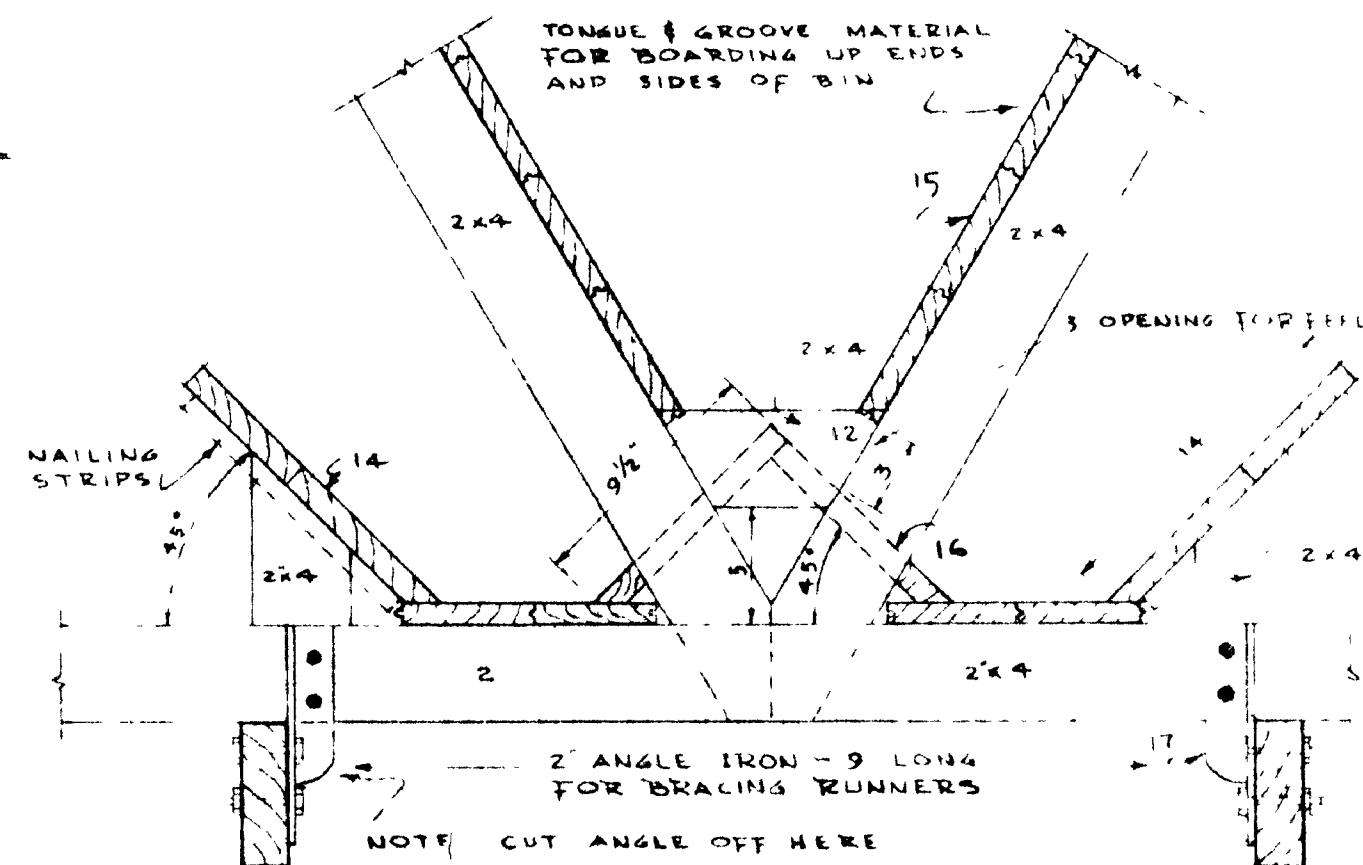

DETAIL A OF FEED TROUGH

THIS PLAN DEVELOPED BY THE FARM SHOP SECTION OF THE AG. ENG AND AG. ED DEPT., VPI

CAPACITY APPROX 50 BU

COOPERATIVE EXTENSION WORK IN AGRICULTURE AND HOME ECONOMICS COLLEGE OF AGRIC & HOME ECON UNIVERSITY OF KENTUCKY LEX. AGRIC ENGR DIVISION

CALF CREEP FEEDER

VA '52 EX 5768 SHEET 1 OF 1

PLAN NO

70 V 8 W 1 1977